



# FY 2027 – FY 2031 Capital Plan

THE  

---

TEXAS A&M  

---

UNIVERSITY  

---

SYSTEM

# Capital Plan Summary

| <i>(\$ in millions)</i>      | <b>Proposed<br/>FY27 – FY31</b> | <b>Prior Year<br/>FY26 – FY30</b> |
|------------------------------|---------------------------------|-----------------------------------|
| Previously Approved Projects | \$5,348.9                       | \$4,647.8                         |
| Proposed Projects            | <u>\$1,455.9</u>                | <u>\$1,925.5</u>                  |
| Total Capital Plan           | \$6,804.8                       | \$6,573.3                         |

## **Funding Source for Proposed Projects:**

|                         |                |                |
|-------------------------|----------------|----------------|
| RFS                     | \$445.3        | \$794.8        |
| PUF                     | \$756.6        | \$432.4        |
| Other                   | <u>\$254.0</u> | <u>\$698.3</u> |
| Total Proposed Projects | \$1,455.9      | \$1,925.5      |

# FY 2027–FY 2031 Funding Sources

| <b>Fiscal Year<br/>(\$ in millions)</b> | <b>Remaining<br/>Planning<br/>Amounts</b> | <b>PUF Debt<br/>Proceeds</b> | <b>RFS Debt<br/>Proceeds</b> | <b>Other</b>     |
|---|---|------------------------------|------------------------------|------------------|
| 2027                                    | \$1,821.8                                 | \$796.2                      | \$592.3                      | \$433.3          |
| 2028                                    | \$1,750.1                                 | \$426.4                      | \$734.5                      | \$589.3          |
| 2029                                    | \$1,295.7                                 | \$287.5                      | \$551.6                      | \$456.6          |
| 2030                                    | \$336.9                                   | \$156.5                      | \$99.1                       | \$81.2           |
| 2031                                    | \$35.9                                    | \$0.0                        | \$0.0                        | \$35.9           |
| <b>Total</b>                            | <b>\$5,240.4</b>                          | <b>\$1,666.6</b>             | <b>\$1,977.5</b>             | <b>\$1,596.3</b> |

# FY 2027–FY 2031 Proposed Capital Plan Projects

**Texas A&M University:**  
See attached sheet

**System Offices:**  
Ballistic Aero-Optics & Materials Range Ph 2 - \$70.6M  
Research & Innovation Building A (Addition) - \$275.0M

**West Texas A&M University:**  
Multipurpose Tornado Safe Building and Shelter - \$14.0M  
Downtown Bus Station Renovation - \$10.7M  
Conner Hall Roof Replacement - \$430K

**Prairie View A&M University:**  
HT Jones Renovations – Gym Wing - \$4.1M  
Public and Allied Health Complex - \$130.0M

**Tarleton State University:**  
Agricultural Sciences Building - \$100.0M  
Cain Street Dorm - \$120.0M  
College of Osteopathic Medicine - \$120.0M  
Parking Garage – Dining Outlet Build-out (Addition) - \$1.4M

**Texas A&M Health Science Center:**  
BioCorridor Health Research & Development Complex – Ph I - \$6.8M  
Health Professions Education Building Lecture Hall Expansion - \$4.5M

**Texas A&M Engineering Extension Service:**  
Swiftwater Rescue Training Prop - \$5.0M

**Texas A&M University – Galveston:**  
Sea Turtle Rehabilitation Hospital & Educational Outreach Center (Addition) - \$2.0M

**Texas A&M University – Kingsville:**  
Land Acquisition - \$3.0M

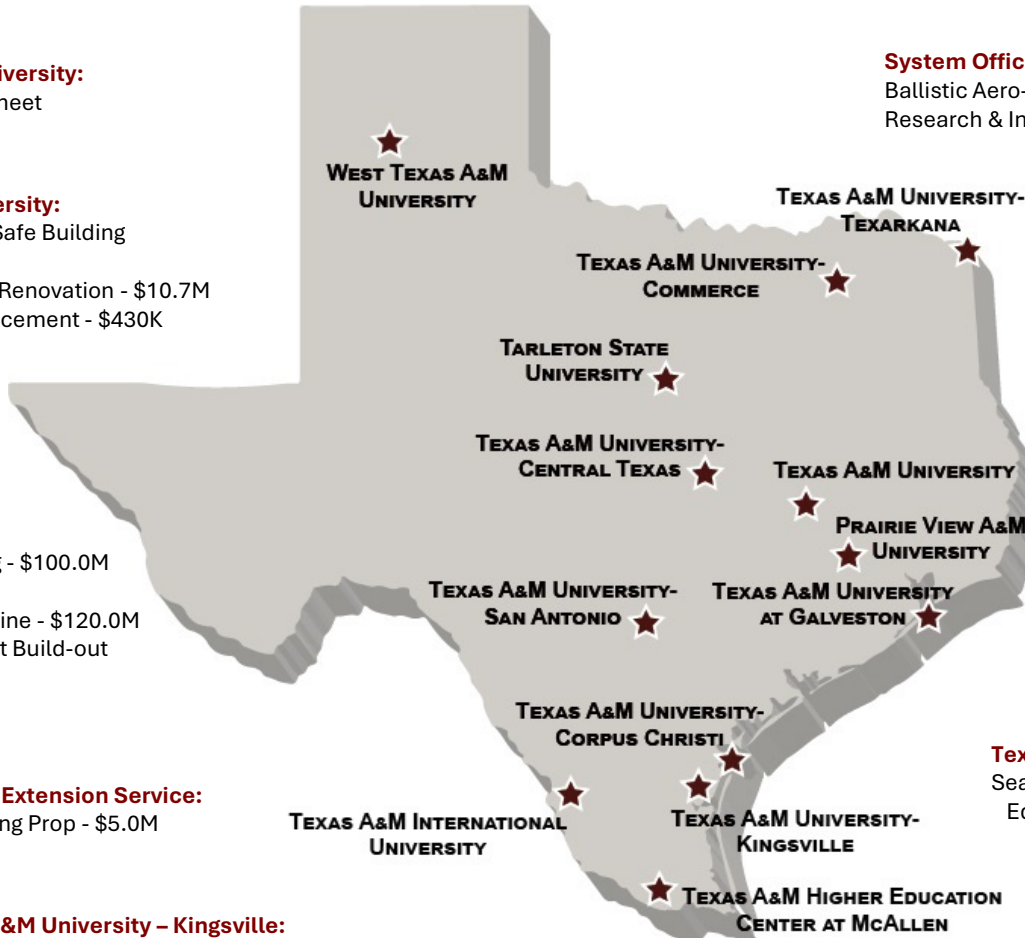

# FY 2027–FY 2031 Proposed Capital Plan Projects

## **Texas A&M University:**

- VetMed Animal Housing Facility – \$18.7M
- Reynolds Medical Sciences Building Level 2 HVAC Upgrades – \$12.7M
- Campus Sanitary & Storm Sewer Collection System Improvements – \$7.9M
- Domestic Water Distribution System Improvements – \$9.3M
- SUP1 – New Chiller 108 & Chillers 101/102 Replacement – \$34.5M
- Thermal Distribution Lines Improvements – \$9.2M
- Domestic Water Well #6 Upgrade – \$20.6M
- Evans Library 6th Floor Renovations – \$17.0M
- CUP HHWHX007 Replacement – \$1.2M
- Engineering Education & Research Complex – \$220.0M
- Domestic Water Loop Extension – \$5.0M
- Evans Library 2nd Floor Renovations – \$7.5M
- West Campus Vivarium – \$135.0M
- Virtual Production Institute Fort Worth – \$25.0M
- Entrepreneurship Building – \$65.0M

# FY 2027–FY 2031 Proposed Projects by Funding Source

| System Member<br>(\$ in millions)          | Planning<br>Amounts | PUF Debt<br>Proceeds | RFS Debt<br>Proceeds | Other          |
|--|---------------------|----------------------|----------------------|----------------|
| Texas A&M University                       | \$588.5             | \$338.4              | \$87.6               | \$162.5        |
| Texas A&M University at Galveston          | \$2.0               | \$0.0                | \$0.0                | \$2.0          |
| Texas A&M University Health Science Center | \$11.3              | \$6.7                | \$0.0                | \$4.5          |
| Prairie View A&M University                | \$134.1             | \$130.0              | \$0.0                | \$4.1          |
| Tarleton State University                  | \$341.3             | \$100.0              | \$240.0              | \$1.3          |
| Texas A&M University – Kingsville          | \$3.0               | \$0.0                | \$0.0                | \$3.0          |
| West Texas A&M University                  | \$25.1              | \$0.0                | \$5.7                | \$19.5         |
| Texas A&M Engineering Extension Service    | \$5.0               | \$5.0                | \$0.0                | \$0.0          |
| System Offices                             | \$345.6             | \$176.5              | \$112.0              | \$57.1         |
| <b>Total</b>                               | <b>\$1,455.9</b>    | <b>\$756.6</b>       | <b>\$445.3</b>       | <b>\$254.0</b> |

# FY 2027 Proposed Projects by Funding Source

| <b>System Member<br/>(\$ in millions)</b> | <b>Planning<br/>Amounts</b> | <b>PUF Debt<br/>Proceeds</b> | <b>RFS Debt<br/>Proceeds</b> | <b>Other</b>   |
|---|-----------------------------|------------------------------|------------------------------|----------------|
| Texas A&M University                      | \$131.0                     | \$5.9                        | \$82.6                       | \$42.5         |
| Texas A&M University at Galveston         | \$2.0                       | \$0.0                        | \$0.0                        | \$2.0          |
| Tarleton State University                 | \$101.3                     | \$100.0                      | \$0.0                        | \$1.3          |
| Texas A&M University – Kingsville         | \$3.0                       | \$0.0                        | \$0.0                        | \$3.0          |
| West Texas A&M University                 | \$0.5                       | \$0.0                        | \$0.0                        | \$0.5          |
| Texas A&M Engineering Extension Service   | \$5.0                       | \$5.0                        | \$0.0                        | \$0.0          |
| System Offices                            | \$345.6                     | \$176.5                      | \$112.0                      | \$57.1         |
| <b>Total</b>                              | <b>\$588.4</b>              | <b>\$287.4</b>               | <b>\$194.6</b>               | <b>\$106.4</b> |

# FY 2027 Proposed Projects

| <b>System Member<br/>(\$ in millions)</b> | <b>Project Name</b>   | <b>Total Planning<br/>Amount</b> |
|---|---|----------------------------------|
| Texas A&M University                      | VetMed Animal Housing Facility  | \$18.7                           |
| Texas A&M University                      | Reynolds Medical Sciences Building Level 2 HVAC Upgrades                    | \$12.7                           |
| Texas A&M University                      | Campus Sanitary & Storm Sewer Collection System Improvements                | \$7.9                            |
| Texas A&M University                      | Domestic Water Distribution System Improvements                             | \$9.3                            |
| Texas A&M University                      | SUP1 – New Chiller 108 & Chillers 101/102 Replacement                       | \$34.5                           |
| Texas A&M University                      | Thermal Distribution Lines Improvements                                     | \$9.2                            |
| Texas A&M University                      | Domestic Water Well #6 Upgrade  | \$20.6                           |
| Texas A&M University                      | Evans Library 6 <sup>th</sup> Floor Renovations                             | \$17.0                           |
| Texas A&M University                      | CUP HHWHX007 Replacement  | \$1.2                            |
| Texas A&M University at Galveston         | Sea Turtle Rehabilitation Hospital & Educational Outreach Center (Addition) | \$2.0                            |

# FY 2027 Proposed Projects (cont'd)

| <b>System Member<br/>(\$ in millions)</b> | <b>Project Name</b>                                 | <b>Total Planning<br/>Amount</b> |
|---|---|----------------------------------|
| Tarleton State University                 | Agricultural Sciences Building                      | \$100.0                          |
| Tarleton State University                 | Parking Garage – Dining Outlet Build-out (Addition) | \$1.3                            |
| Texas A&M University – Kingsville         | Land Acquisition                                    | \$3.0                            |
| West Texas A&M University                 | Conner Hall Roof Replacement                        | \$0.5                            |
| Texas A&M Engineering Extension Service   | Swiftwater Rescue Training Prop                     | \$5.0                            |
| System Offices                            | Ballistic Aero-Optics & Materials Range Ph 2        | \$70.6                           |
| System Offices                            | Research & Innovation Building A (Addition)         | \$275.0                          |

**Total FY 2027 Proposed Projects** **\$588.4**  
**Authorization for Pre-Construction Services** **\$53.9**

# PUF Bonds 5Year Debt Forecast

## Proposed FY 2027-FY 2031 Capital Plan

### Potential New Projects

|   | FY 2026          | FY 2027          | FY 2028          | FY 2029          | FY 2030          | FY 2031          |
|---|------------------|------------------|------------------|------------------|------------------|------------------|
| Outstanding Bonds (9/1)                       | \$1,503.0        | \$1,862.0        | \$2,396.4        | \$2,579.5        | \$2,726.2        | \$2,771.3        |
| Principal Payments - Existing Bonds           | (\$62.1)         | (\$65.7)         | (\$68.0)         | (\$71.0)         | (\$70.5)         | (\$72.8)         |
| New Bond Issuances (as of August 25)          | \$485.0          | \$318.0          | \$142.0          | \$130.0          | \$127.0          | —                |
| Δ in New Bond Issuances (Nov 25 and Feb 26)   | —                | \$320.1          | \$31.8           | (\$64.6)         | (\$72.7)         | —                |
| Principal Payments - New Bonds                | (\$13.9)         | (\$32.5)         | (\$39.3)         | (\$41.6)         | (\$43.6)         | —                |
| <b>2027 Cap Plan New Projects - New Bonds</b> | —                | <b>\$46.0</b>    | <b>\$172.0</b>   | <b>\$252.0</b>   | <b>\$160.0</b>   | —                |
| Principal Payments New Projects               | —                | (\$1.5)          | (\$5.5)          | (\$8.0)          | (\$5.1)          | —                |
| AUF Cash for Capital Projects                 | (\$50.0)         | (\$50.0)         | (\$50.0)         | (\$50.0)         | (\$50.0)         | —                |
| <b>Outstanding Bonds (8/31)</b>               | <b>\$1,862.0</b> | <b>\$2,396.4</b> | <b>\$2,579.5</b> | <b>\$2,726.2</b> | <b>\$2,771.3</b> | <b>\$2,698.5</b> |

### PUF Capacity Conservative (3% annual growth)

|     |     |     |     |     |     |
|-----|-----|-----|-----|-----|-----|
| 52% | 65% | 68% | 69% | 68% | 65% |
|-----|-----|-----|-----|-----|-----|

\*Actual 20-year CAGR of PUF book value = 7.6%

# RFS Bonds 5 Year Debt Forecast

## Proposed FY 2027-FY 2031 Capital Plan

### Potential New Projects

|   | FY 2026          | FY 2027          | FY 2028          | FY 2029          | FY 2030          | FY 2031          |
|---|------------------|------------------|------------------|------------------|------------------|------------------|
| Outstanding Bonds (9/1)                       | \$3,194.3        | \$3,490.0        | \$3,762.8        | \$3,983.5        | \$4,158.8        | \$4,284.9        |
| Principal Payments - Existing Bonds           | (\$232.2)        | (\$240.4)        | (\$222.2)        | (\$224.8)        | (\$204.0)        | (\$213.9)        |
| New Bond Issuances (as of August 25)          | \$536.0          | \$320.0          | \$315.0          | \$315.0          | \$310.0          | —                |
| Δ in New Bond Issuances (Nov 25 and Feb 26)   | —                | \$193.1          | \$103.5          | \$31.9           | —                | —                |
| Principal Payments - New Bonds                | (\$8.1)          | (\$16.2)         | (\$38.4)         | (\$40.6)         | (\$42.1)         | —                |
| <b>2027 Cap Plan New Projects - New Bonds</b> | —                | <b>\$16.5</b>    | <b>\$63.7</b>    | <b>\$95.3</b>    | <b>\$63.1</b>    | —                |
| Principal Payments New Projects               | —                | (\$0.2)          | (\$1.0)          | (\$1.4)          | (\$0.9)          | —                |
| <b>Outstanding Bonds (8/31)</b>               | <b>\$3,490.0</b> | <b>\$3,762.8</b> | <b>\$3,983.5</b> | <b>\$4,158.8</b> | <b>\$4,284.9</b> | <b>\$4,071.0</b> |



# Bush Combat Development Complex – ALIAS Texas Hangar

The Texas A&M University System

Bryan, TX

Project No. 01-3471

Brett McCully

Chief Facilities Officer

The Texas A&M University System

THE  
TEXAS A&M  
UNIVERSITY  
SYSTEM

# POR Cover Page

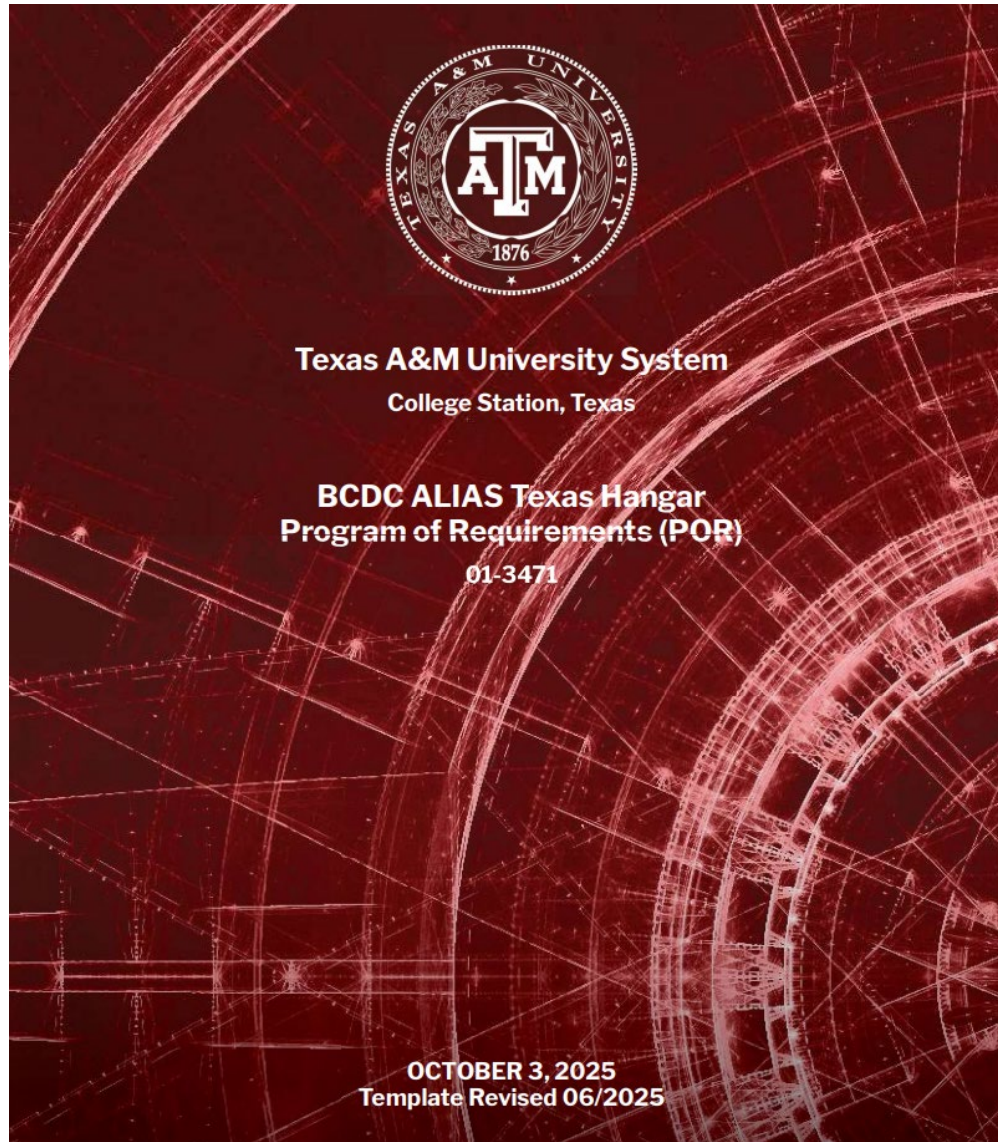

THE  
TEXAS A&M  
UNIVERSITY  
SYSTEM

# Site Location



# Site Plan











⊕ BCDC ALIAS TEXAS HANGAR

THE  
TEXAS A&M  
UNIVERSITY  
SYSTEM

# Floor Plan

## COLOR LEGEND

|  |  |
|--|--|
|  ADMINISTRATION |  HANGAR BAY |
|  BREAK          |  STORAGE    |
|  CIRCULATION    |  SUPPORT    |
|  CLASSROOM      |  UTILITY    |

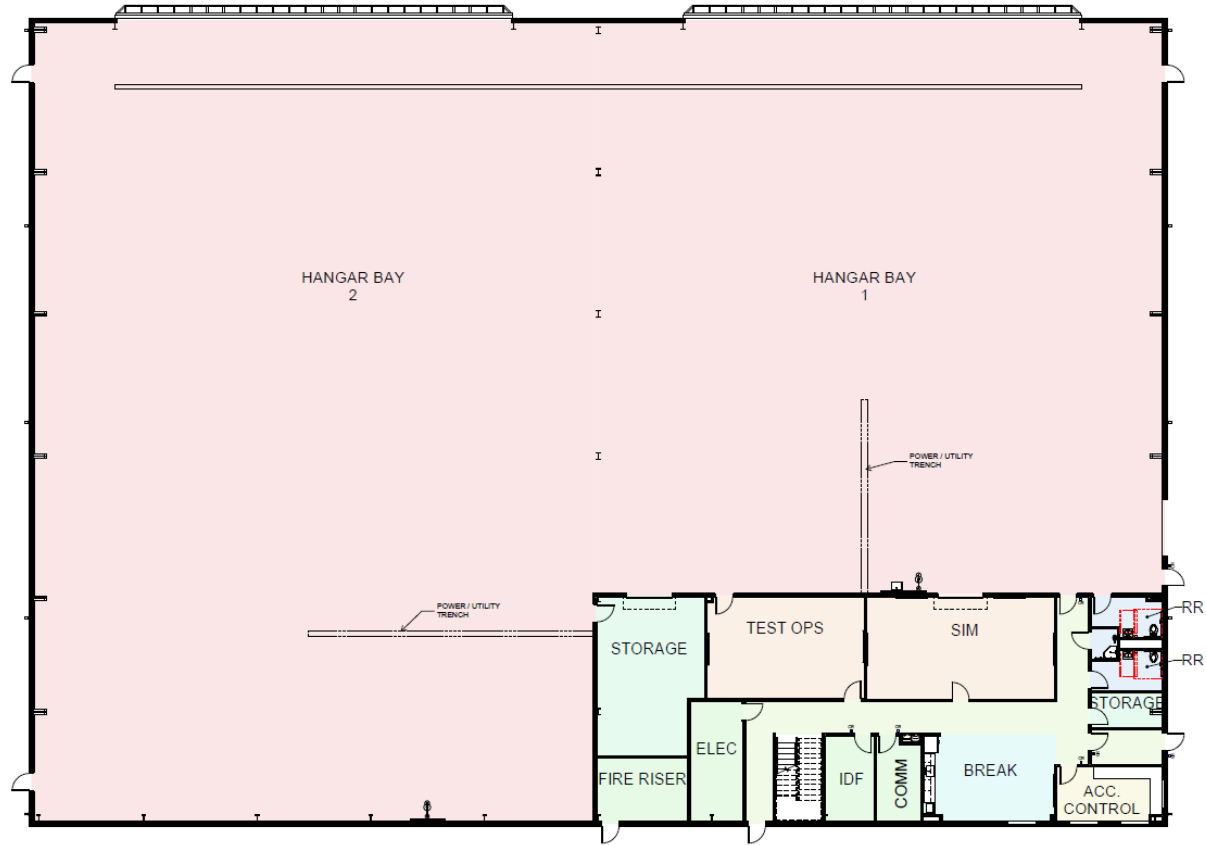
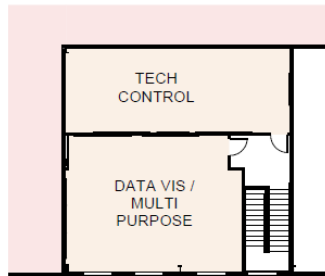

# Perspective

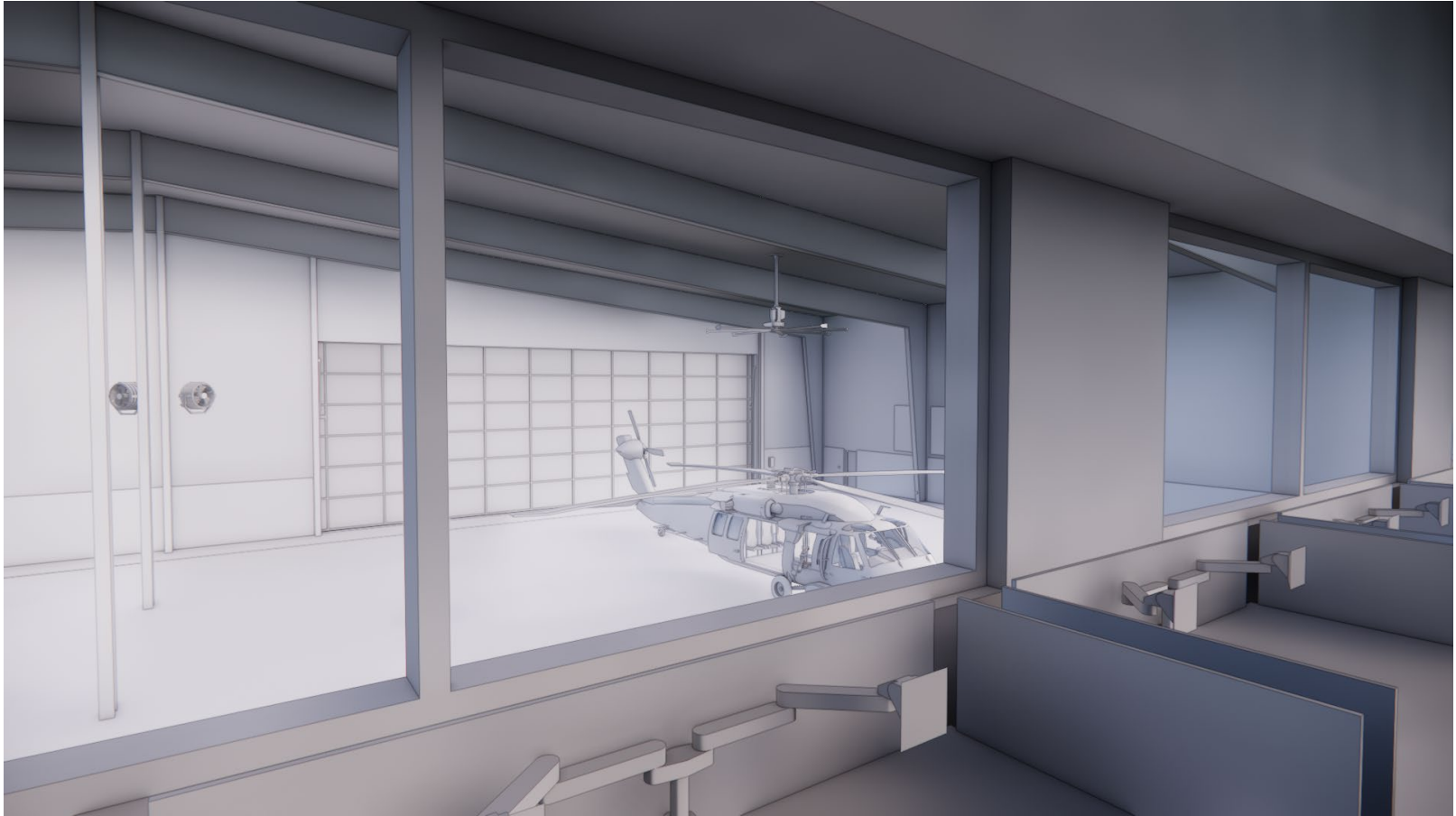

# Perspective



# Perspective

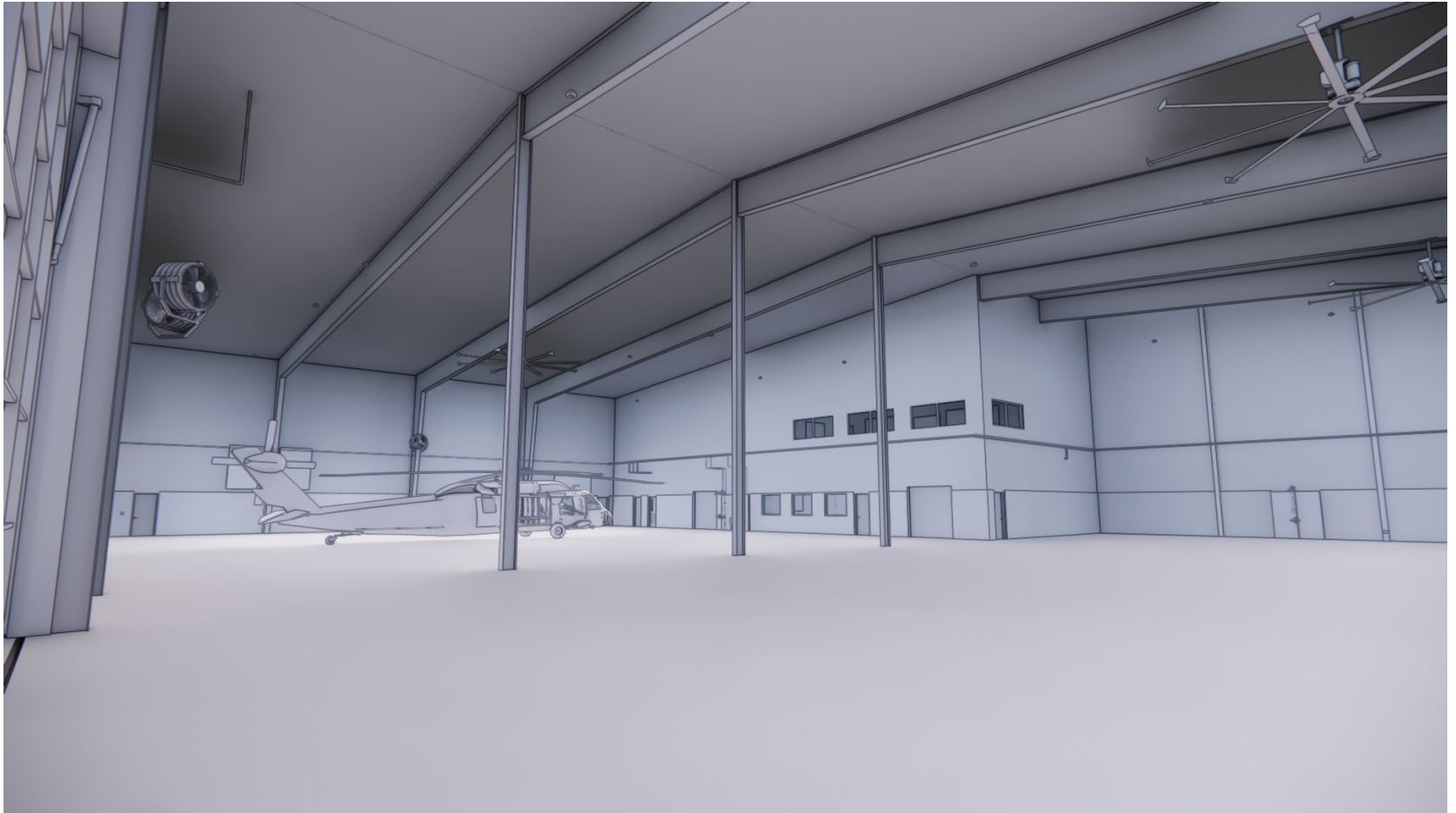

THE  
TEXAS A&M  
UNIVERSITY  
SYSTEM



# Satellite Utility Plant 1 (SUP 1) Expansion

Texas A&M University  
College Station, TX  
Project No. 02-3434

Brett McCully  
Chief Facilities Officer  
The Texas A&M University System



THE  
TEXAS A&M  
UNIVERSITY  
SYSTEM

# POR Cover Page



Program of Requirements (POR) for the  
Satellite Utility Plant 1 (SUP1) Expansion  
Project No. 02-3434

Final - June 2024

THE  
TEXAS A&M  
UNIVERSITY  
SYSTEM

# Site Location



# Site Plan

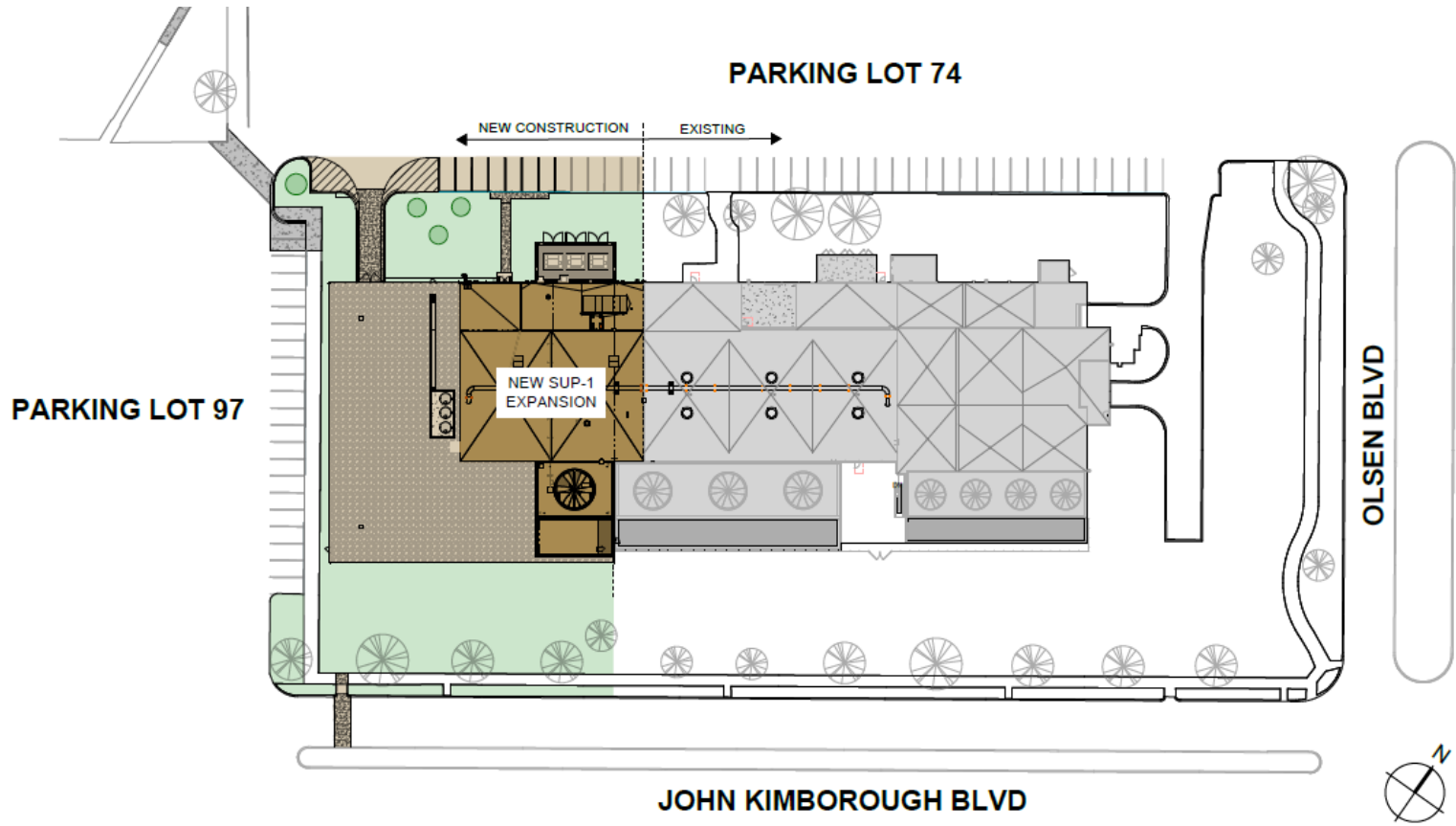

# Floor Plan

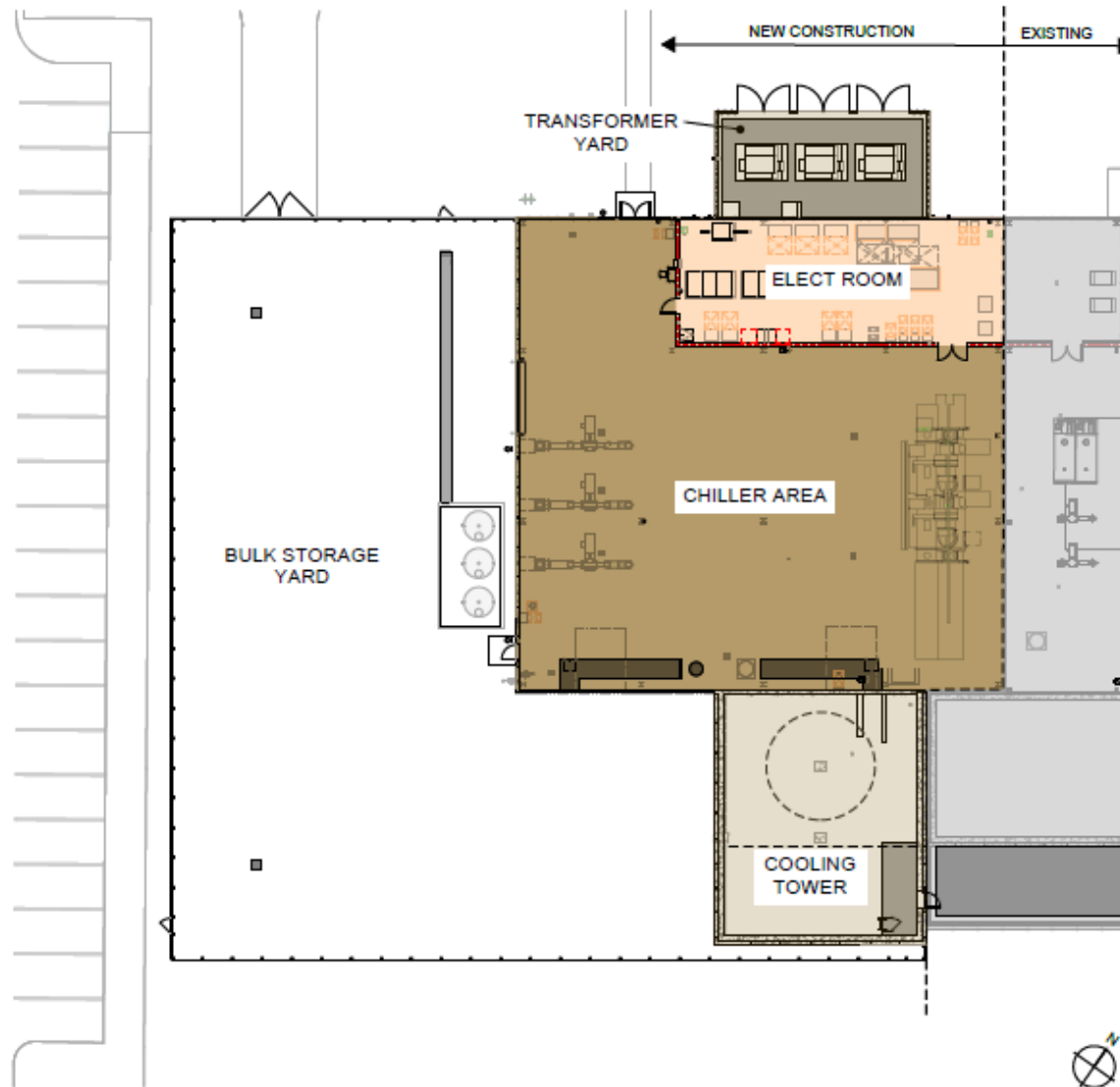

# Perspective



THE  
TEXAS A&M  
UNIVERSITY  
SYSTEM



# Academic Building Exterior Restoration

Texas A&M University  
College Station, TX  
Project No. 02-3464

Brett McCully  
Chief Facilities Officer  
The Texas A&M University System



THE  
TEXAS A&M  
UNIVERSITY  
SYSTEM

# POR Cover Page



Program of Requirements (POR) for:

## **Academic Building Exterior Restoration**

Project #02-3464

Final – June 10, 2025



377 Houston Street  
College Station, TX 77840

THE  
TEXAS A&M  
UNIVERSITY  
SYSTEM

# Site Location

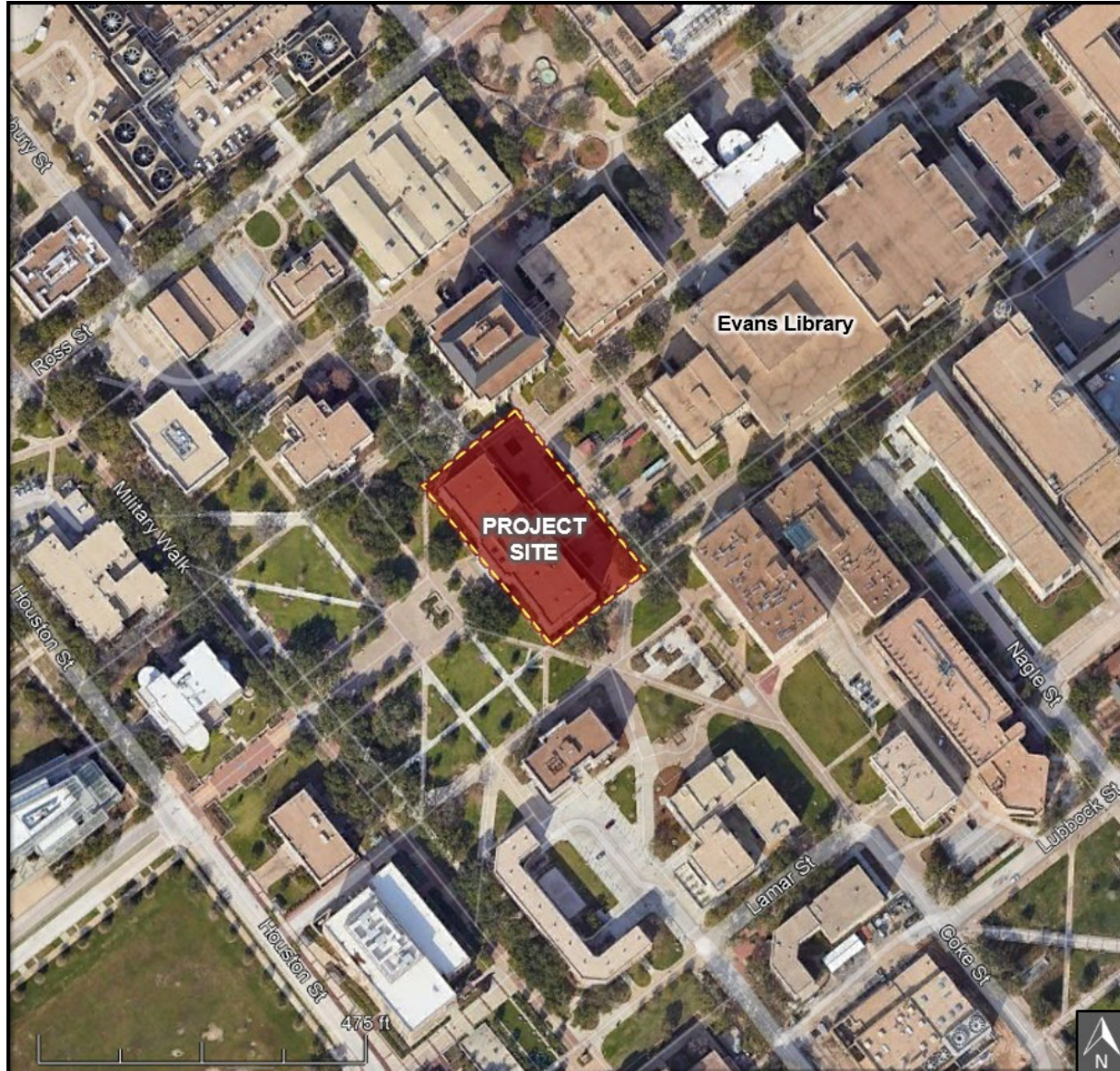

THE  
TEXAS A&M  
UNIVERSITY  
SYSTEM



# Masonry Restoration



THE  
TEXAS A&M  
UNIVERSITY  
SYSTEM

# Roof Restoration

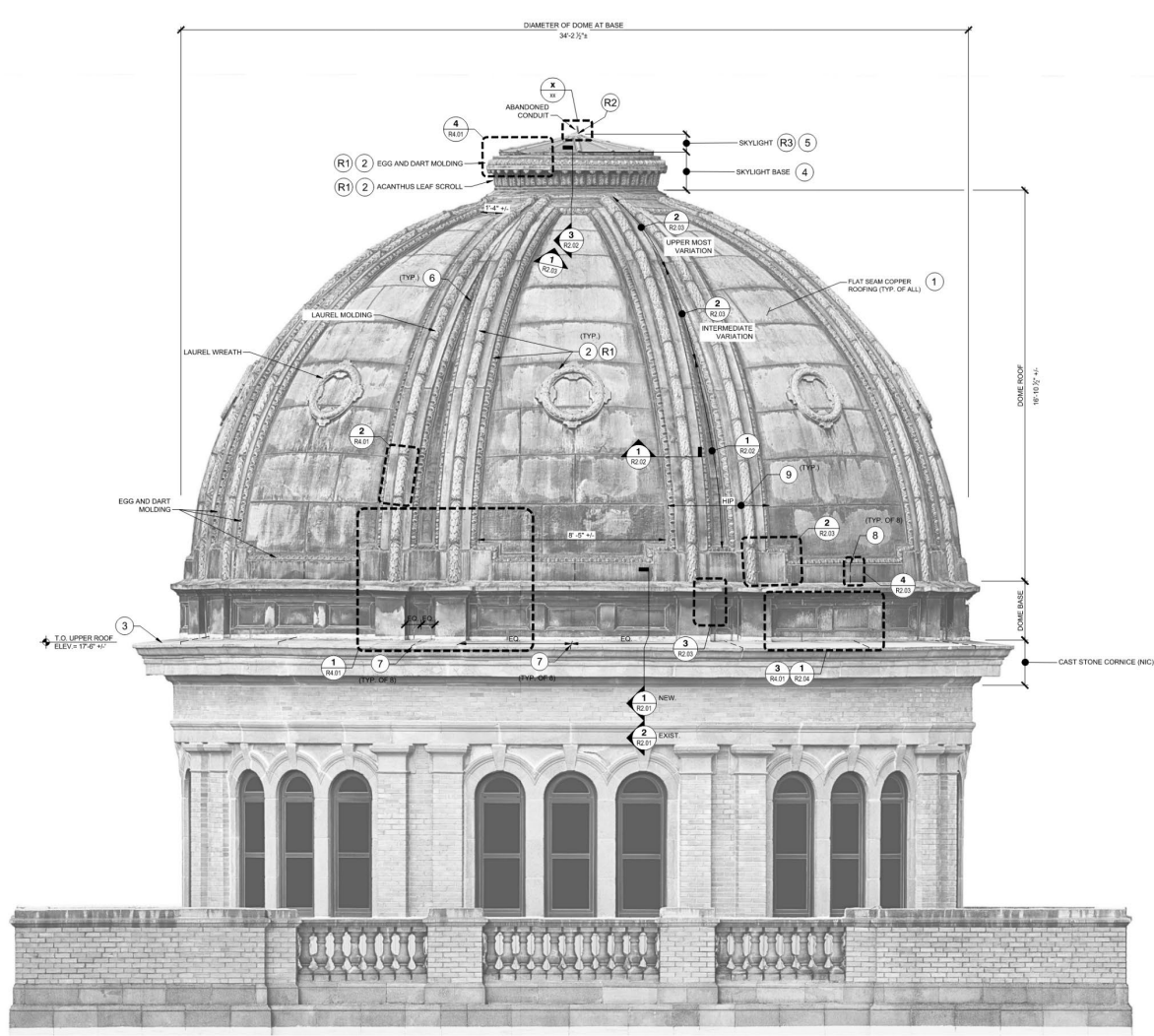



# Alkek IBT Building Lab Expansion | Renovation & EnMed Build-Out

Texas A&M University Health Science Center

Houston, TX

Project No. 23-3320

Brett McCully  
Chief Facilities Officer  
The Texas A&M University System



TEXAS A&M UNIVERSITY  
**HEALTH**

THE  
TEXAS A&M  
UNIVERSITY  
SYSTEM

# POR Cover Page

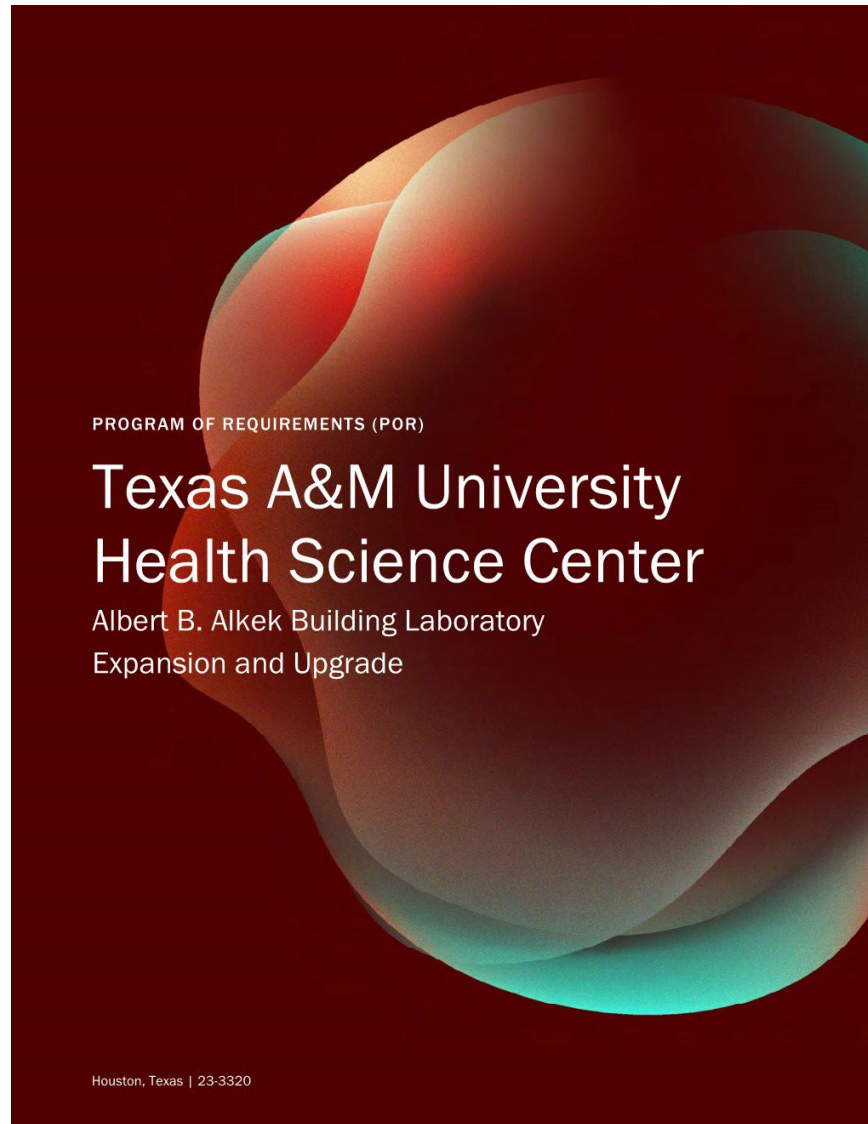

PROGRAM OF REQUIREMENTS (POR)

## Texas A&M University Health Science Center

Albert B. Alkek Building Laboratory  
Expansion and Upgrade

Houston, Texas | 23-3320

# Site Location



# Alkek IBT | Laboratory Floor Plan Levels 4-7



- Break Room
- Conference
- Laboratory
- Non-Assignable
- Open Office
- Private Office

# EnMed | Office Floor Plan Level 8



- Break Room
- Conference
- Non-Assignable
- Not in Scope
- Office
- Visitor

# Perspective





# Research & Innovation Building A

The Texas A&M University System

Fort Worth, TX

Project No. 01-3477

Brett McCully  
Chief Facilities Officer  
The Texas A&M University System

THE  
TEXAS A&M  
UNIVERSITY  
SYSTEM

# Site Location



# Site Plan

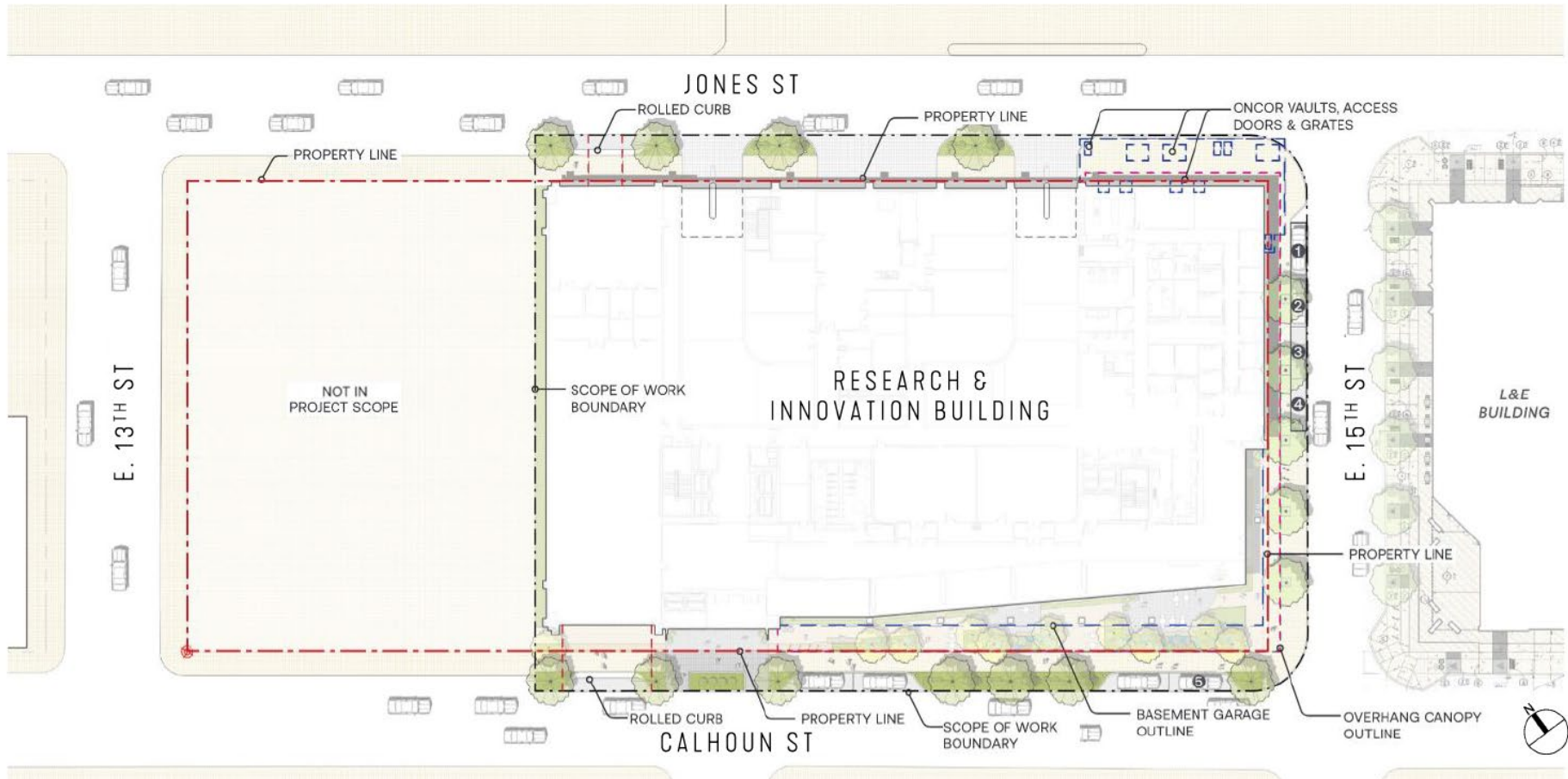

# Floor Plan

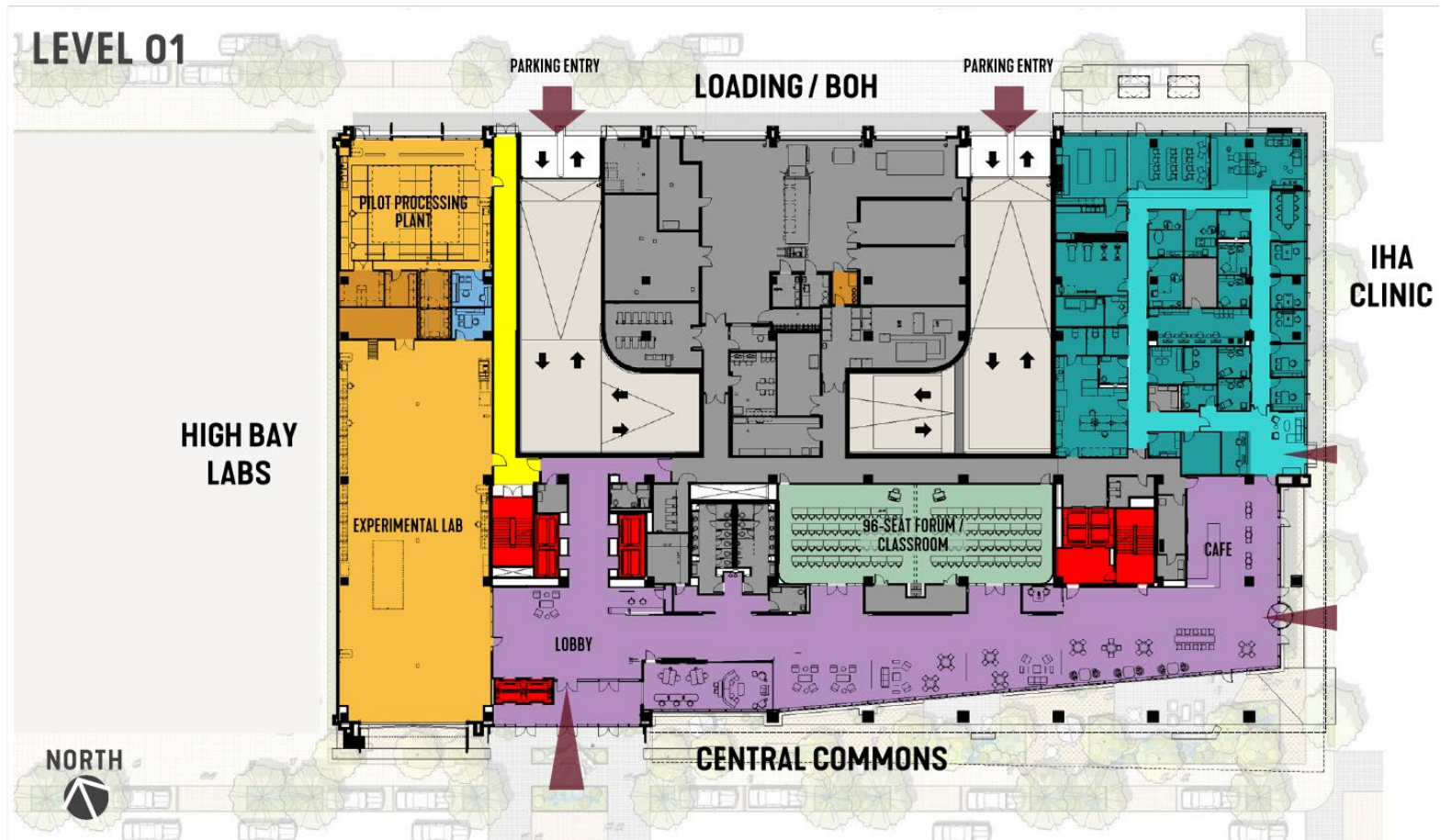



# Penberthy Turf Replacement

Texas A&M University  
College Station, TX  
Project No. 2025-06734

Les Williams  
Senior Associate Vice President and  
Chief Facilities Officer  
Facilities & Energy Services  
Texas A&M University



THE  
TEXAS A&M  
UNIVERSITY  
SYSTEM

# POR Cover Page



**TEXAS A&M**  
UNIVERSITY®

College Station, TX

Statement of Work (SOW)

## **Penberthy Turf Replacement**

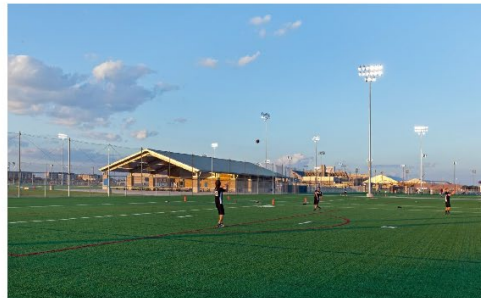

**Project No. 2025-06734**

Final | June 10, 2025  
Template Revised 06/02/2022

**THE**  
**TEXAS A&M**  
**UNIVERSITY**  
**SYSTEM**

# Site Location



# Site Plan

