

Map

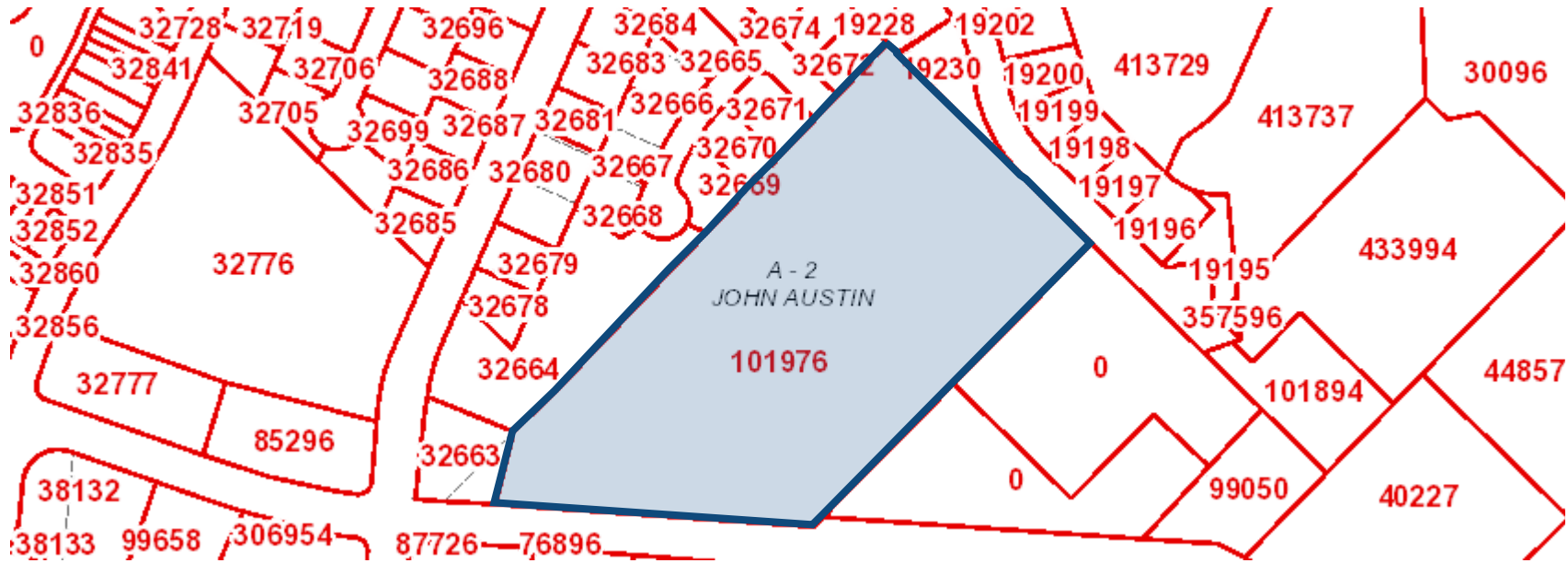

Property Details

Account	
Property ID:	101976
Legal Description:	ST JOSEPH PROFESSIONAL PARK, BLOCK 1, LOT 1, ACRES 11.1
Geographic ID:	584690-0001-0010
Agent:	
Type:	Real
Location	
Address:	E 29TH ST
Map ID:	549-224,552-224

Neighborhood CD:	E15000.C
Owner	
Owner ID:	52579
Name:	ST JOSEPH REGIONAL HEALTH CENTER
Mailing Address:	DBA HEALTH POINT MEMORIAL 2801 FRANCISCAN DR BRYAN, TX 77802-2544
% Ownership:	100.0%
Exemptions:	For privacy reasons not all exemptions are shown online.

 Property Values

Improvement Homesite Value:	\$0
Improvement Non-Homesite Value:	\$0
Land Homesite Value:	\$0
Land Non-Homesite Value:	\$1,450,548
Agricultural Market Valuation:	\$0
Market Value:	\$1,450,548
Ag Use Value:	\$0
Appraised Value:	\$1,450,548

Homestead Cap Loss: ⓘ	\$0
Assessed Value:	\$1,450,548

VALUES DISPLAYED ARE 2022 CERTIFIED VALUES UNLESS THE PROPERTY HAS AN ACTIVE PROTEST.

Information provided for research purposes only. Legal descriptions and acreage amounts are for appraisal district use only and should be verified prior to using for legal purpose and or documents. Please contact the Appraisal District to verify all information for accuracy.

Property Taxing Jurisdiction

Entity	Description	Tax Rate	Market Value	Taxable Value
C1	CITY OF BRYAN	0.624000	\$1,450,548	\$1,450,548
CAD	APPRAISAL DISTRICT	0.000000	\$1,450,548	\$1,450,548
G1	BRAZOS COUNTY	0.429411	\$1,450,548	\$1,450,548
S1	BRYAN ISD	1.139600	\$1,450,548	\$1,450,548
ZRFND	Z REFUND ENTITY	0.000000	\$1,450,548	\$1,450,548

Total Tax Rate: 2.193011

Property Land

Type	Description	Acreage	Sqft	Eff Front	Eff Depth	Market Value	Prod. Value
9	>=5 ACRES	11.1	483,516.00	0.00	0.00	\$1,450,548	\$0

Property Roll Value History

Year	Improvements	Land Market	Ag Valuation	Appraised	HS Cap Loss	Assessed
2023	N/A	N/A	N/A	N/A	N/A	N/A
2022	\$0	\$1,450,548	\$0	\$1,450,548	\$0	\$1,450,548
2021	\$0	\$942,856	\$0	\$942,856	\$0	\$942,856
2020	\$0	\$942,856	\$0	\$942,856	\$0	\$942,856
2019	\$0	\$942,860	\$0	\$942,860	\$0	\$942,860
2018	\$0	\$942,860	\$0	\$942,860	\$0	\$942,860
2017	\$0	\$942,860	\$0	\$942,860	\$0	\$942,860
2016	\$0	\$942,860	\$0	\$942,860	\$0	\$942,860
2015	\$0	\$942,860	\$0	\$942,860	\$0	\$942,860
2014	\$0	\$942,860	\$0	\$942,860	\$0	\$942,860
2013	\$0	\$942,860	\$0	\$942,860	\$0	\$942,860
2012	\$0	\$942,860	\$0	\$942,860	\$0	\$942,860

Property Deed History

Deed Date	Type	Description	Grantor	Grantee	Volume	Page	Number
8/31/2012	WD	WARRANTY DEED	TAU ENTERPRISES INC	ST JOSEPH REGIONAL HEALTH CENTER	10877	283	01131159
12/31/2003	WD	WARRANTY DEED	ST JOSEPH REGIONAL HEALTH CENTER	TAU ENTERPRISES INC	5800	049	

1/15/1998	WD	WARRANTY DEED	MCDONOUGH LOUISE LUZA	ST JOSEPH REGIONAL HEALTH CENTER	3016	013	
1/5/1998	PLAT	PLAT FILED	MCDONOUGH LOUISE LUZA	MCDONOUGH LOUISE LUZA	3006	315	