



Bryan, TX



Original Design



Enhanced landscaped perimeter
Rod-iron fence
Roll-up doors visible from street

Revised Design



Enhanced landscaped perimeter
Pre-cast Concrete/stucco wall with enhanced design along
northern side of property
Roll-up doors not visible from street

Pre-cast Concrete/stucco wall with enhanced design along northern perimeter

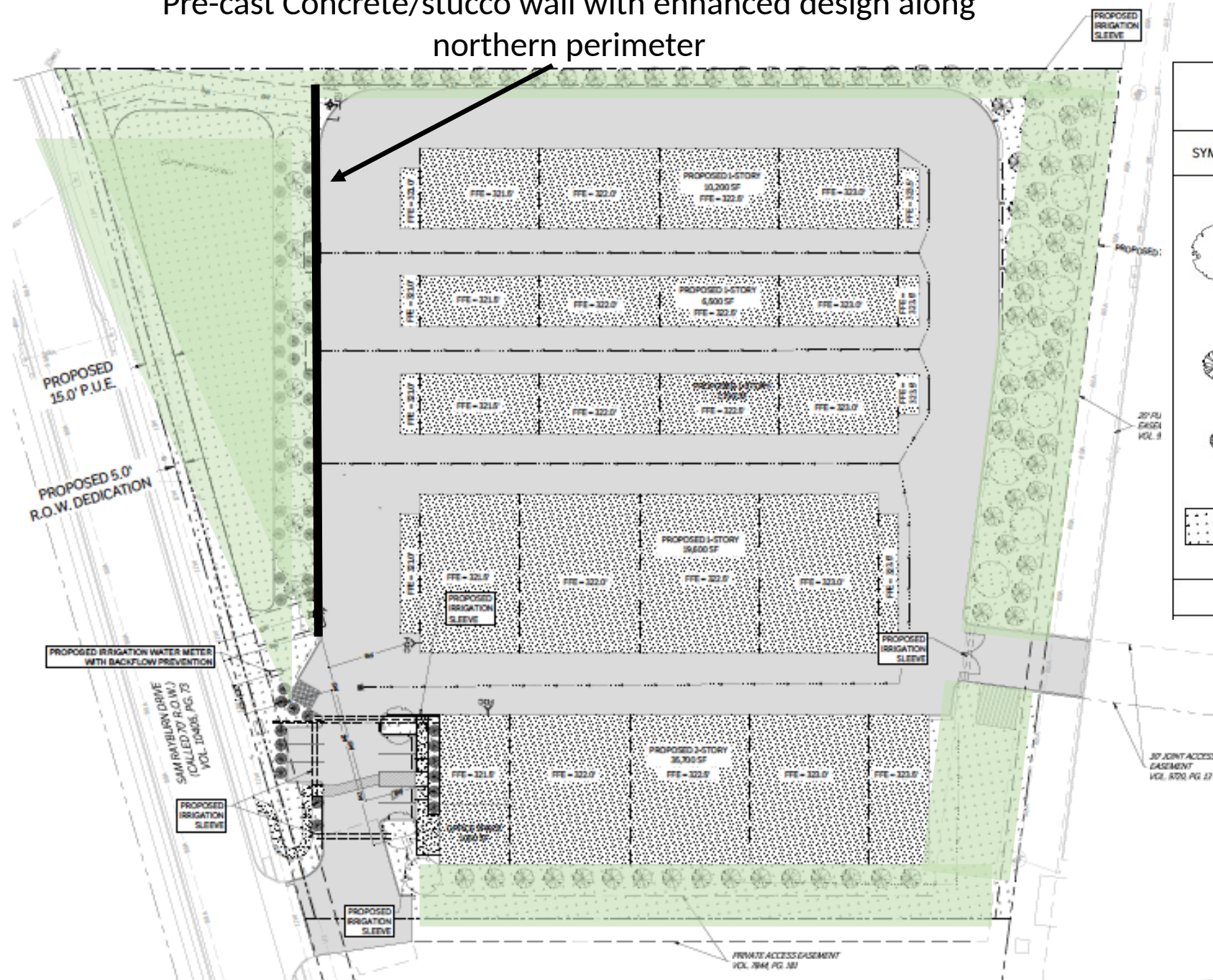

LANDSCAPING POINT CALCULATIONS					
SYMBOL	QUANTITY	SIZE	NAME & TYPE	SF VALUE	TOTAL SF
	18	GREATER THAN 3"	CANOPY TREES: LIVE OAK TREE (Quercus virginiana)	350	6,300
	85	GREATER THAN 3"	NON-CANOPY TREES: CREPE MYRTLES (Lagerstroemia Indica)	225	19,125
	47	2 GALLON MAXIMUM 18"	DWARF SHRUBS: DWARF YAUPON HOLLY (Ilex Vomitoria 'Nana')	10	470
	57,637	SF	GROUNDCOVER: COMMON BERMUDA GRASS (Cynodon dactylon)	$\frac{10}{100}$ SF	864*
TOTAL LANDSCAPE SF POINTS					26,759

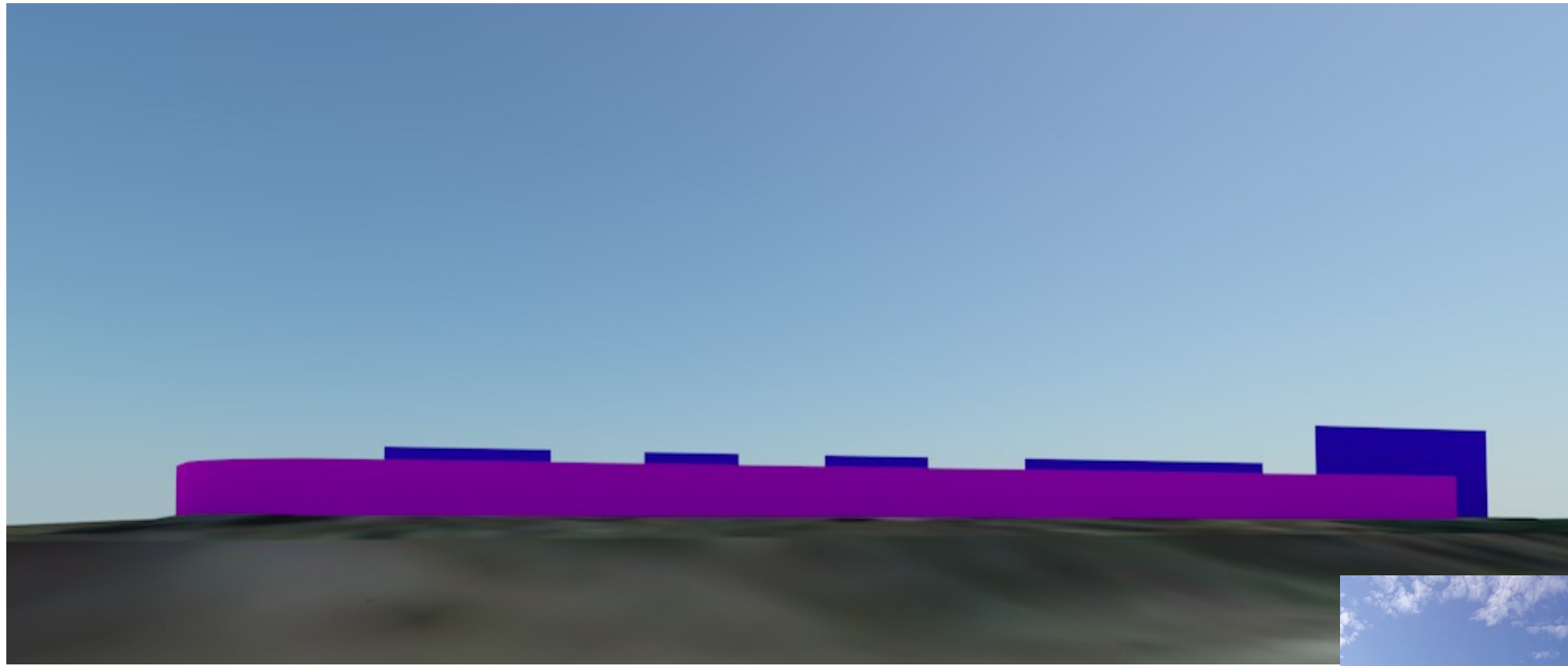

Line of Sight visibility down Sam Rayburn
Wall constructed to shield roll-up doors



Examples



Features

- Opaque wall made from pre-cast concrete or stucco
- 8 ft. tall
- A masonry design finish and/or stucco façade with masonry elements that matches building design
- Shields visibility of roll-up doors in back buildings
- Landscaping plan to ensure additional screening



Bryan, TX

