

**PBK K-12**

# Additions & Renovations to Jane Long Middle School

Bryan Independent School District \ Bryan, Texas

**Design Presentation**

January 11, 2015





The information contained in this booklet describes the design for the Renovations and Additions to Jane Long Middle School. The new facility will incorporate the addition of 7 classrooms including one science classroom and one art classroom, along with new restrooms to serve the new classroom spaces. The new classrooms will be located along the south face of the existing building and will be incorporated to match with the existing construction.

Additional planned improvements will include a new security vestibule at the school entrance, updates to the administration restrooms for accessibility, upgrades to the kitchen, replacing existing fire alarm devices, and adding color to the existing corridors.



# OVERALL FLOOR PLAN

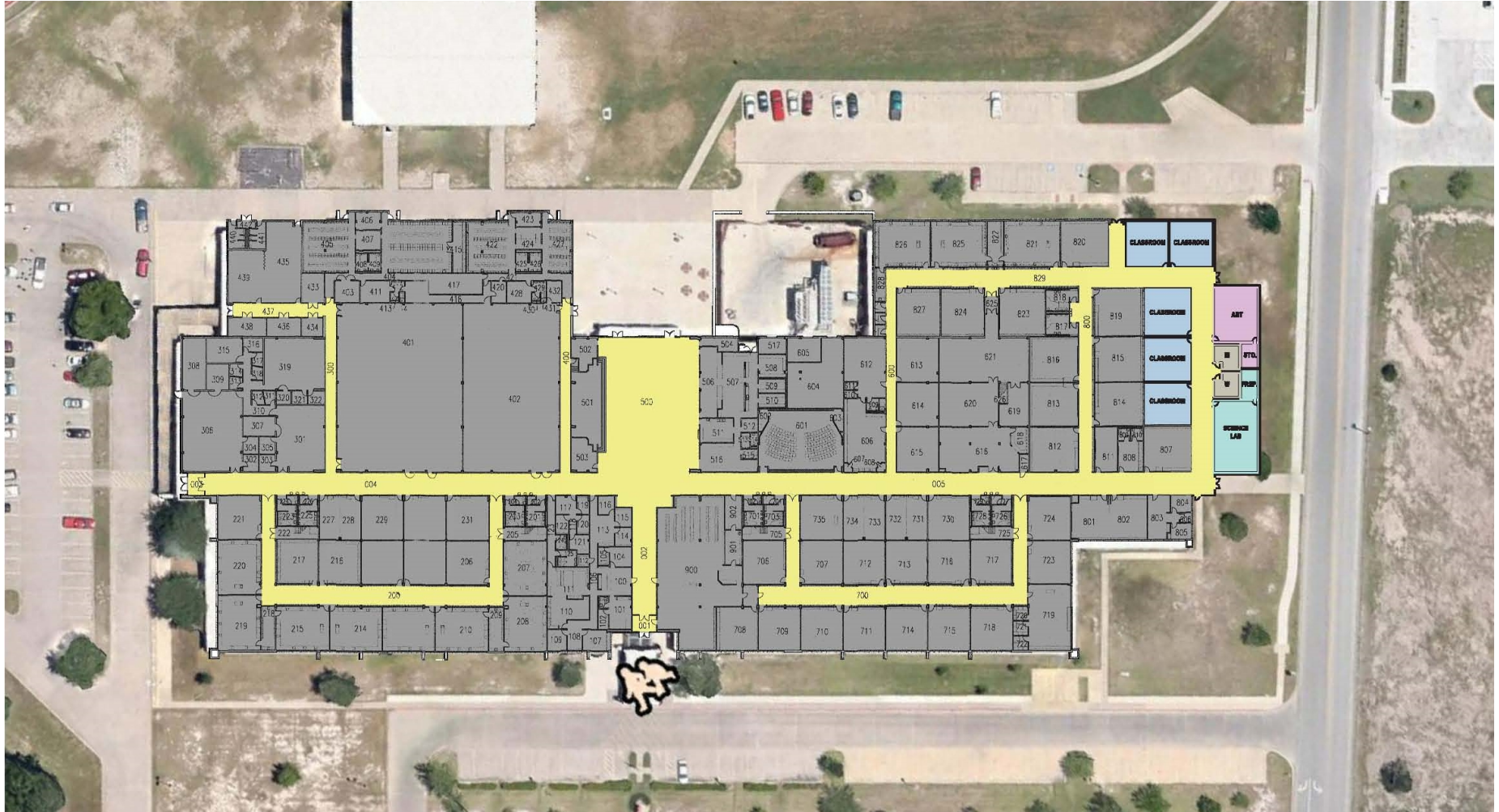

# ENLARGED FLOOR PLAN

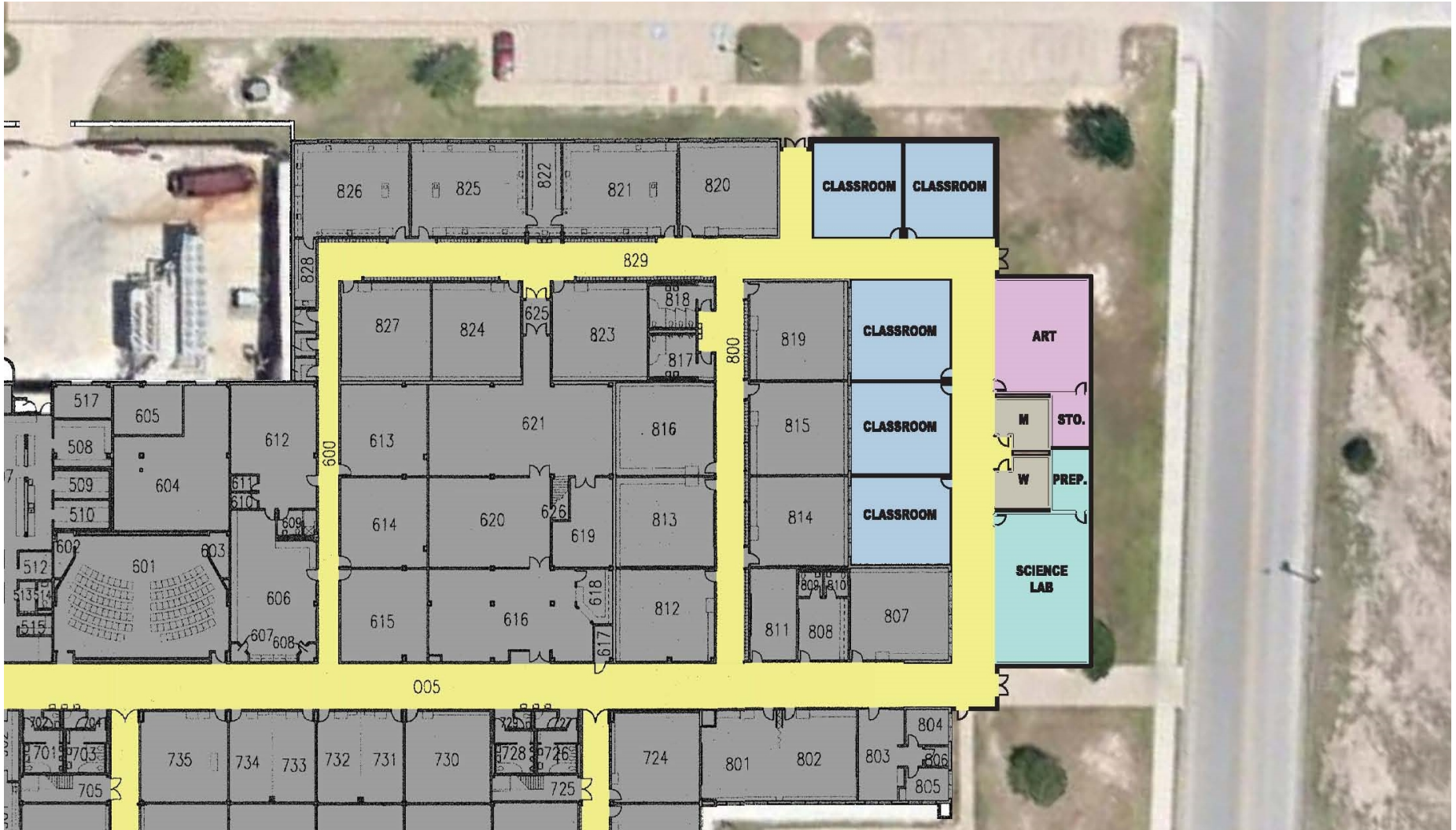



# EXTERIOR IMAGE



# PROBABLE PROJECT COSTS

---

## Renovations and Additions to Jane Long Elementary School

---

- Addition of seven (7) classrooms, one (1) science and one (1) art, with restrooms
  - Add a security vestibule at building entry
  - Renovate existing administration restrooms for accessibility
  - Upgrades to the existing Kitchen
  - Replace fire alarm devices
  - Add color to the existing corridors
- 

### Total Estimated Project

**Cost.....\$2,311,170.00**

Funds Available for

Construction.....\$2,311,170.00

Project Soft

Costs.....\$346,675.00

---

Professional Fees

Geotech Reports, Surveys, Material Testing

Fixtures, Furniture & Equipment

**Total Established Project Cost.....\$2,657,845.00**

*Note that the allowance for Construction Inflation, as established in the 2014 Bond Referendum, has not been included in the costs shown above.*



*Thank You*

INDEPENDENT  
SCHOOL DISTRICT