

Crockett | Henderson & Jones Elementary Schools | Additions & Renovations

Bryan Independent School District | Bryan, TX | December 14, 2015



 Stantec

CROCKETT ELEMENTARY SCHOOL



HENDERSON ELEMENTARY SCHOOL



JONES ELEMENTARY SCHOOL

Board of Trustees and Administration

Board of Trustees

Dr. Douglas Wunneburger	Board President
William T. "Trey" Moore	Vice President
Felicia Benford	Secretary
David Stasny	Member
Mark McCall	Member
Ruthie Waller	Member
John Street	Member

Administration

Dr. Thomas A. Wallis	Superintendent
Dr. Timothy Rocka	Deputy Superintendent
Ms. Amy Drozd	Assistant Superintendent of Business Services
Barbara Ybarra	Associate Superintendent of Teaching & Learning
Jeff Windsor	Director of Construction Services

Site Plan with Proposed Additions



Floor Plan with Proposed Additions

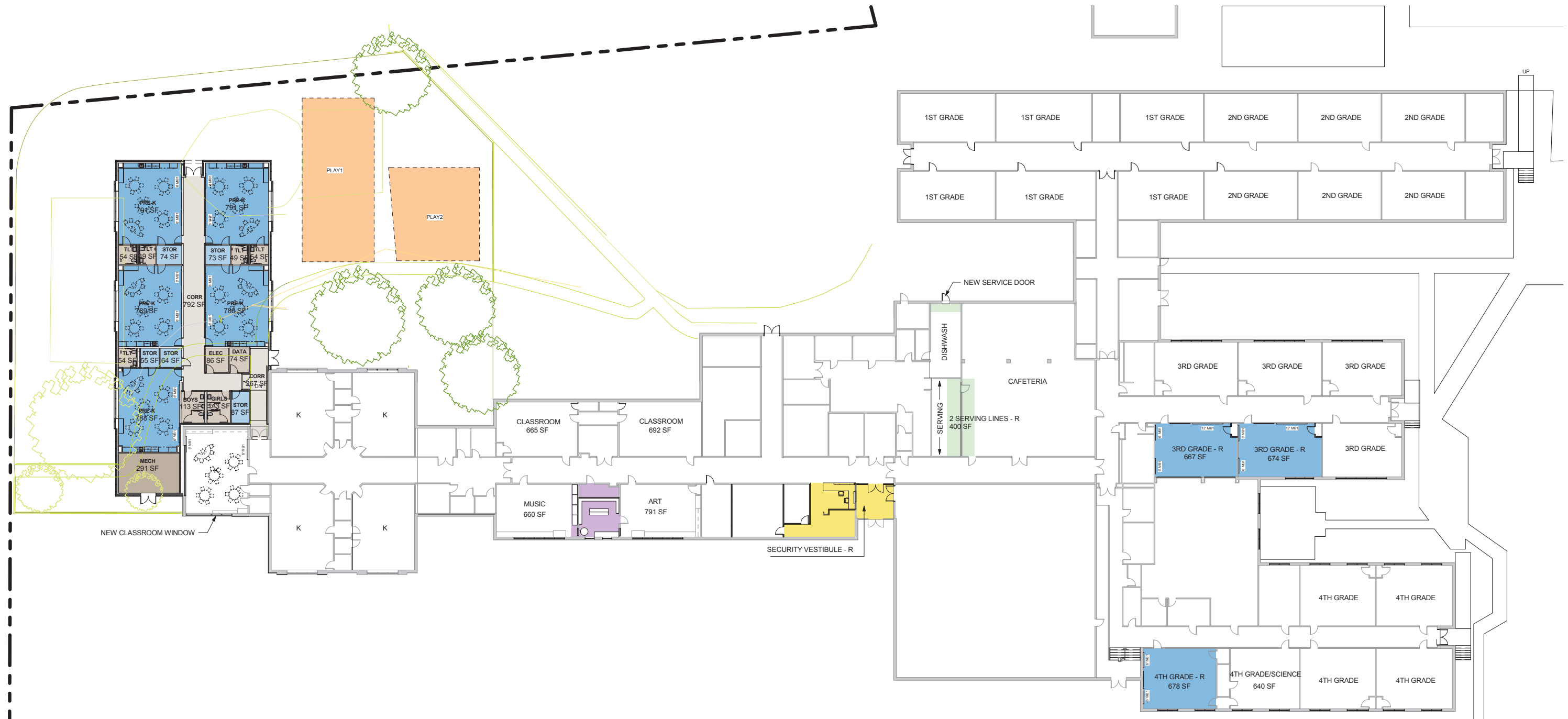

Floor Plan Color Key

Academic		Food Service Support	
Academic Support		MEP / Data	
Fine Arts		Toilet Rooms	
Fine Arts Support		Primary Circulation	
Food Service		Security Vestibule	

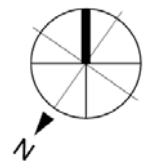

Classroom Addition

Bond Improvements:

New (7,205 GSF)

- Academic
 - 5 Pre-K Classrooms
- Building Support
 - 7 Student Restrooms
 - MEP Building Systems
 - Storage rooms

Renovation (3,542 NSF)

- Music Storage
- Art Storage
- Elec
- 3 Classrooms
- Kitchen (2 Serving Lines)
- New Kitchen Service Door
- Security Vestibule

Floor Plan Color Key

- Academic
- Academic Support
- Fine Arts
- Fine Arts Support
- Food Service

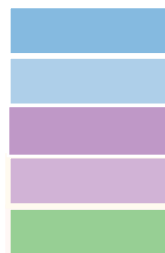



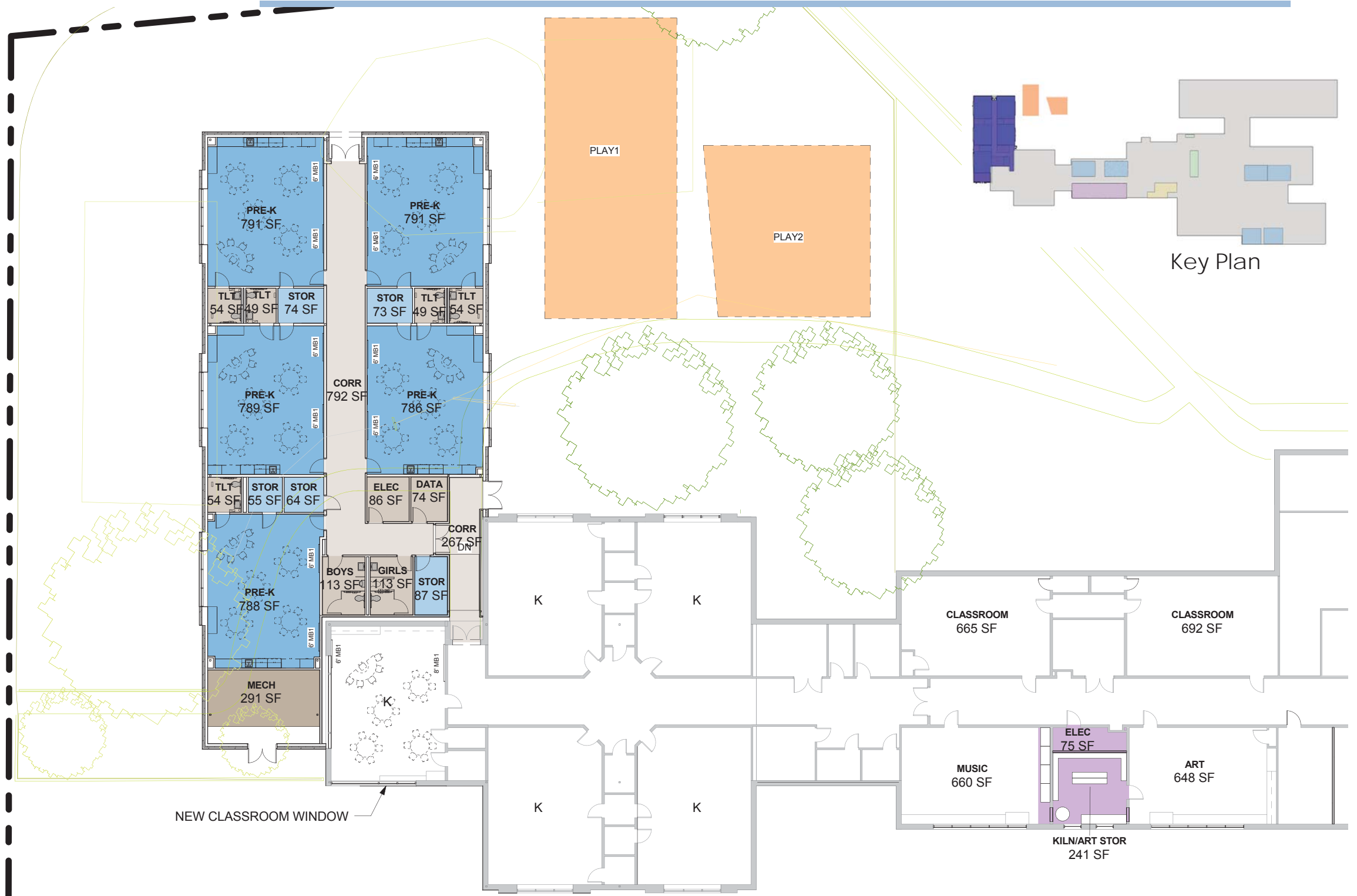
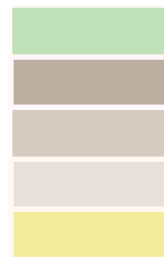

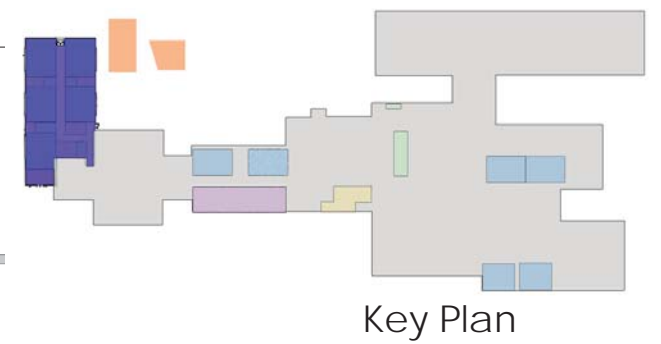
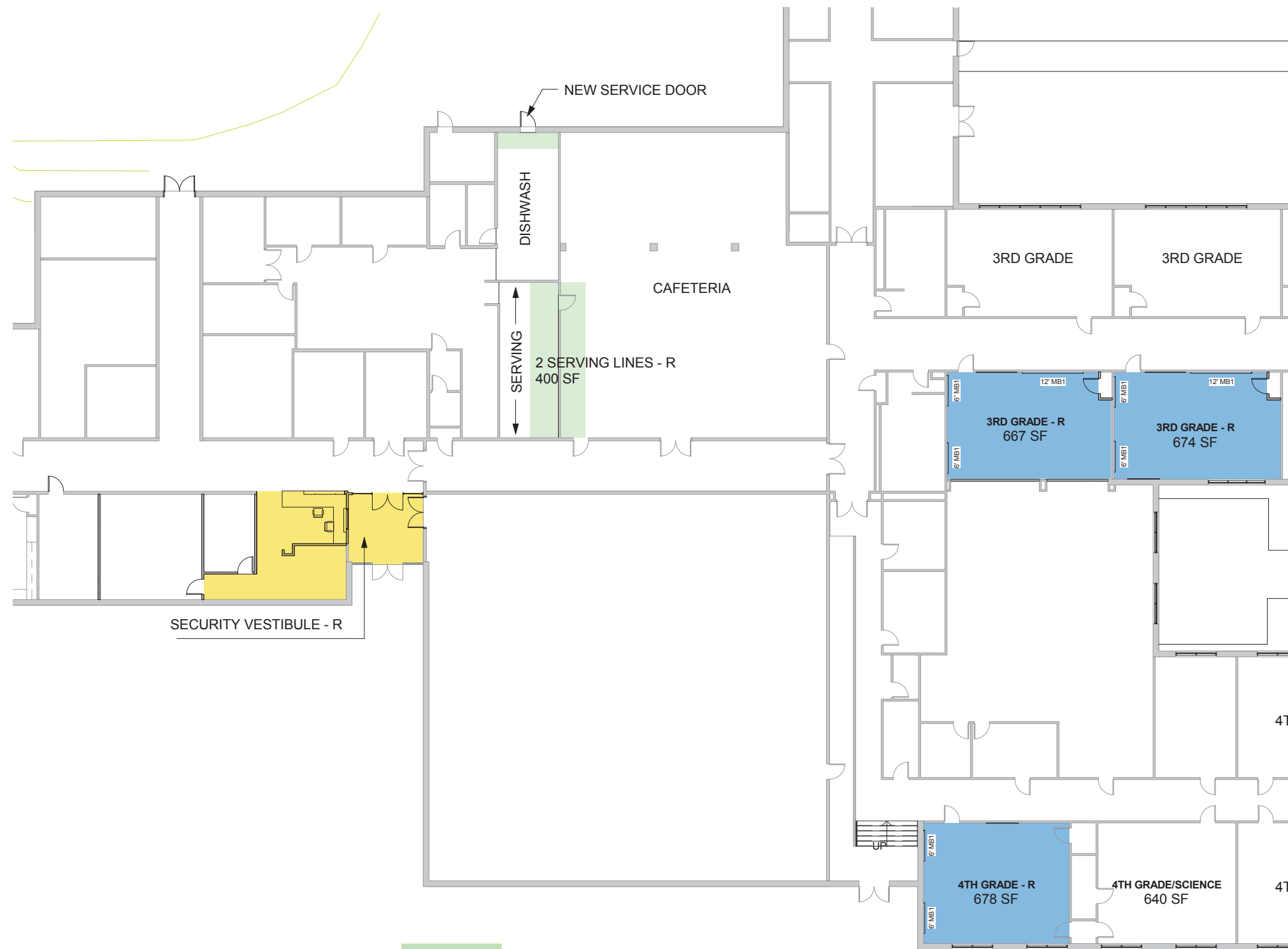

- Food Service Support
- MEP / Data
- Toilet Rooms
- Primary Circulation
- Security Vestibule



Security Vestibule Renovation



Floor Plan Color Key

- | | | | |
|-------------------|---|----------------------|---|
| Academic |  | Food Service Support |  |
| Academic Support |  | MEP / Data |  |
| Fine Arts |  | Toilet Rooms |  |
| Fine Arts Support |  | Primary Circulation |  |
| Food Service |  | Security Vestibule |  |

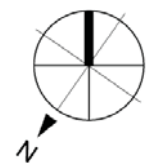

Exterior Renderings









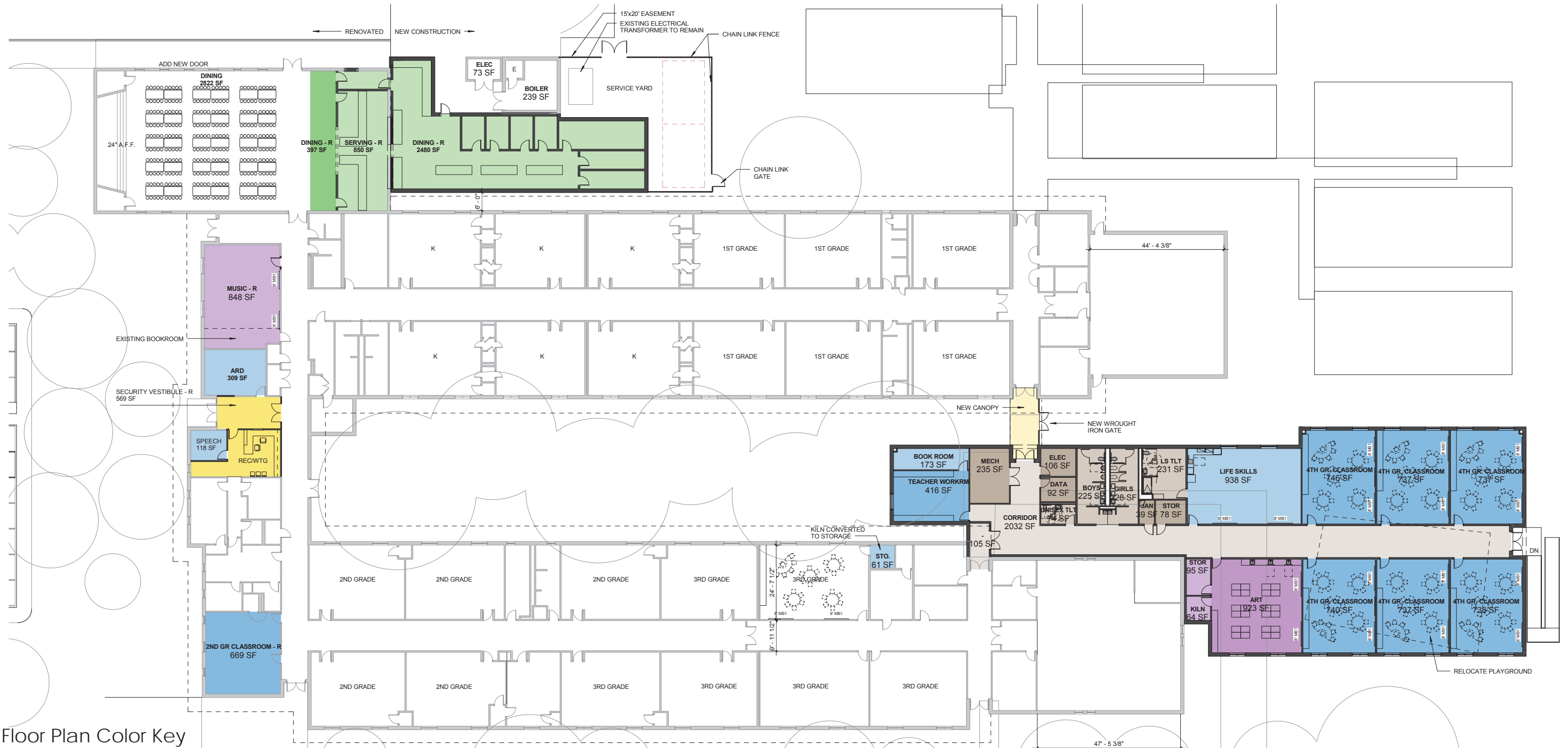

Site Plan with Proposed Additions



Floor Plan with Proposed Additions

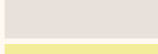

Floor Plan Color Key

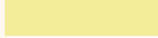
Academic		Food Service Support	
Academic Support		MEP / Data	
Fine Arts		Toilet Rooms	
Fine Arts Support		Primary Circulation	
Food Service		Security Vestibule	



Dining Addition & Renovation

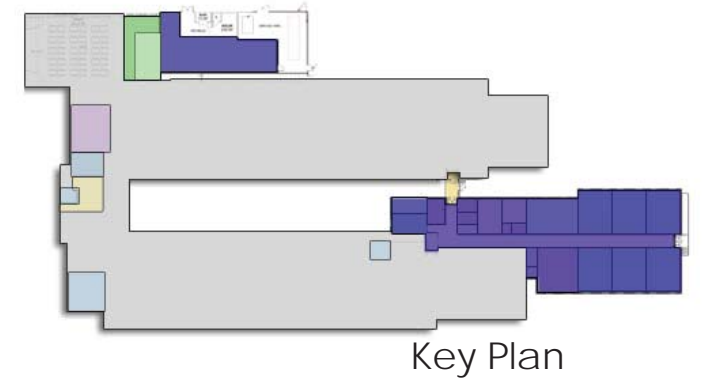

Bond Improvements:

New (14,103 GSF)

- **Academic**
 - 6 Classrooms & Life Skills Classroom
 - Art, Art Storage, Art Kiln
 - Book Room
 - Teacher Workroom
- **Building Support**
 - 2 Student Restrooms
 - Teacher Restroom
 - Life Skills Restroom
 - MEP Building Systems
 - Janitor & Storage rooms
- **Dining**
 - Kitchen/Serving
- **Relocated Chiller/Yard**
- **New Canopy & Wrought Iron Gate**

Renovation (3,732 NSF)

- 1 Classroom
- Dining/Serving
- Music
- Security Vestibule
- ARD
- Speech
- Storage

Floor Plan Color Key

Academic		Food Service Support	
Academic Support		MEP / Data	
Fine Arts		Toilet Rooms	
Fine Arts Support		Primary Circulation	
Food Service		Security Vestibule	





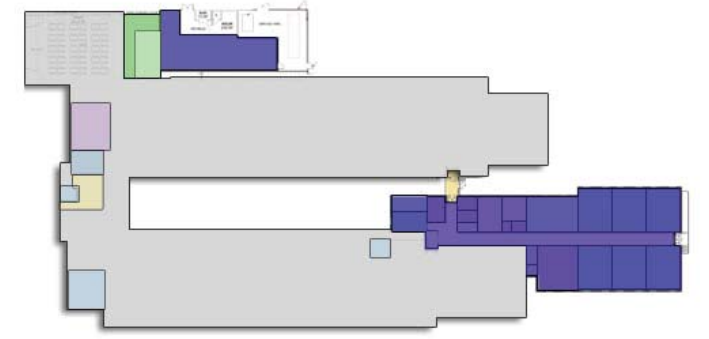



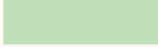

Classroom Addition

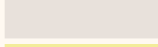

Key Plan

Floor Plan Color Key

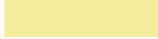
Academic		Food Service Support	
Academic Support		MEP / Data	
Fine Arts		Toilet Rooms	
Fine Arts Support		Primary Circulation	
Food Service		Security Vestibule	



Exterior Rendering



Exterior Re-facing of Dining



EXISTING DINING FACADE



OPTION 1: STAIN



OPTION 2: BRICK

Site Plan with Proposed Additions



NEW AUTO DROP OFF
ENTRANCE FOYER & CANOPY

PECAN ST

PALASOTA DR

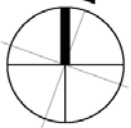

Floor Plan with Proposed Renovations



Floor Plan Color Key

Carpet/Resilient Base



Toilet Partitions & Urinal Screens



Carpet/Resilient Base & Computer Countertops

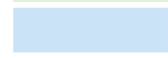

VCT



Mirrors & Toilet Partitions/ Urinal Screens



Damaged Sidewalks



Security Vestibule

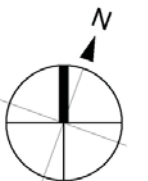

Canopy Rendering



EXISTING DROP OFF ENTRANCE



NEW DROP OFF ENTRANCE WITH CANOPY

Project Schedule

Presentation to Board of Trustees.....	<i>December 14, 2015</i>
Construction Documents Review - 100%.....	<i>January 26, 2016</i>
Release for Competitive Sealed Proposals.....	<i>February 1, 2016</i>
Receive Bids.....	<i>March 1, 2016</i>
Award Construction Contract by Board.....	<i>March 21, 2016</i>
Start Construction.....	<i>April 1, 2016</i>
Substantial Completion of Project..... (12 months of Construction)	<i>April 1, 2017</i>
Project Close-Out (60 days).....	<i>June 1, 2017</i>