



**PBK K-12**

# Additions and Renovations to Johnson Elementary School

Bryan Independent School District \ Bryan, Texas

Design Presentation

November 16, 2015



## PROJECT SUMMARY



The new facility will incorporate the addition of 7 classrooms, along with new accessible restrooms to serve the new classroom spaces. The new classrooms will be located within the existing courtyard areas and will feature clerestory windows to allow natural light into the new classroom spaces. The garden located within the existing eastern courtyard will be relocated to another area on the site as a part of this project. The new classrooms will incorporate the “open concept” style of the existing classrooms and will be fluidly connected to the existing classroom spaces in order to preserve the open nature of the school.

Additional planned improvements will include a new security vestibule at the school entrance, updates at the existing restrooms including new finishes, adding a fire sprinkler system to serve the entire building, and the replacement of all existing building roofing. An alternate will be provided for adding a new parking aisle at the front entry drive which will also serve to increase the drop-off stacking space.



# EXISTING CONDITIONS





# COMPOSITE SITE PLAN

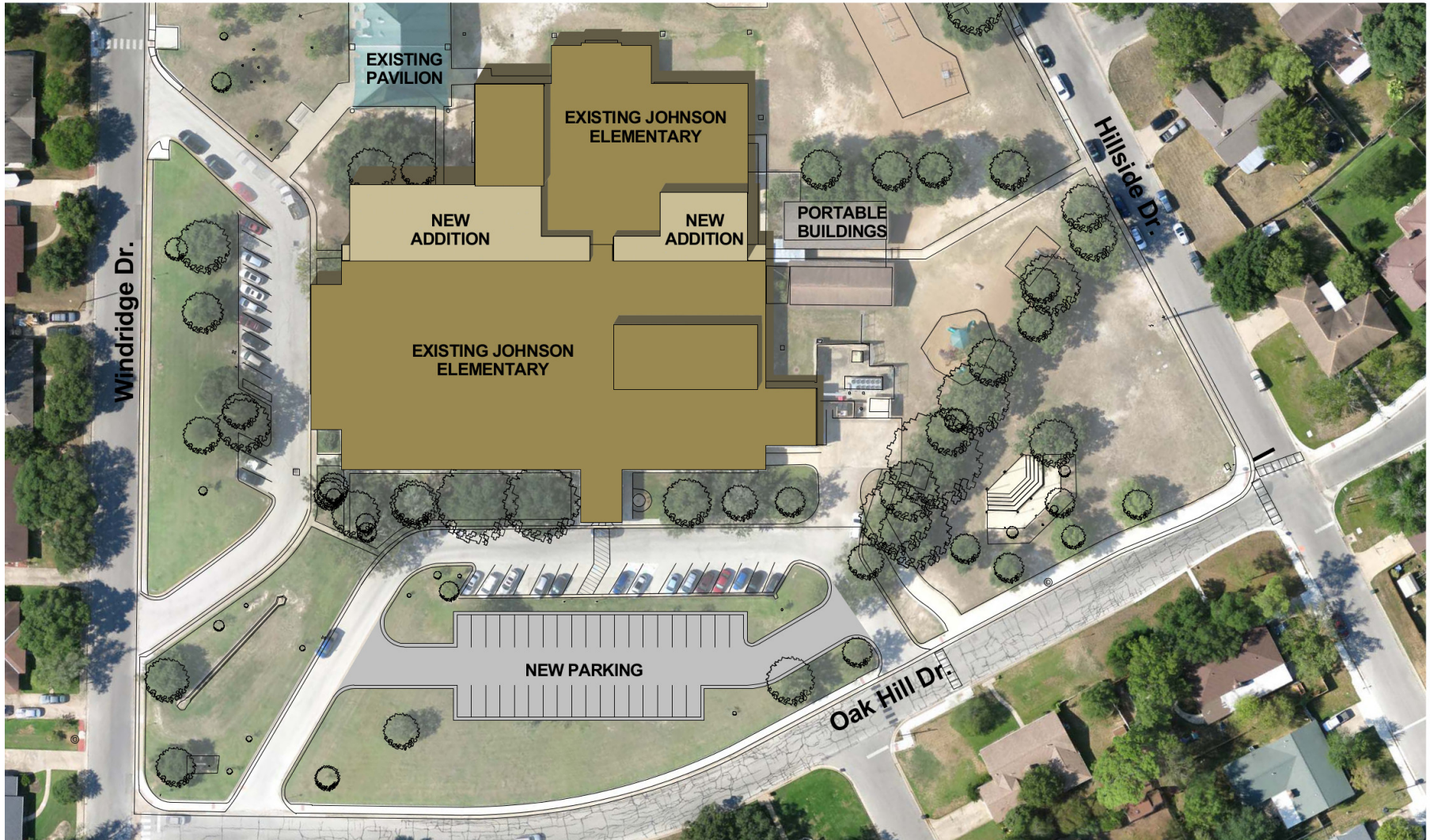



# ENLARGED FLOOR PLAN - WEST

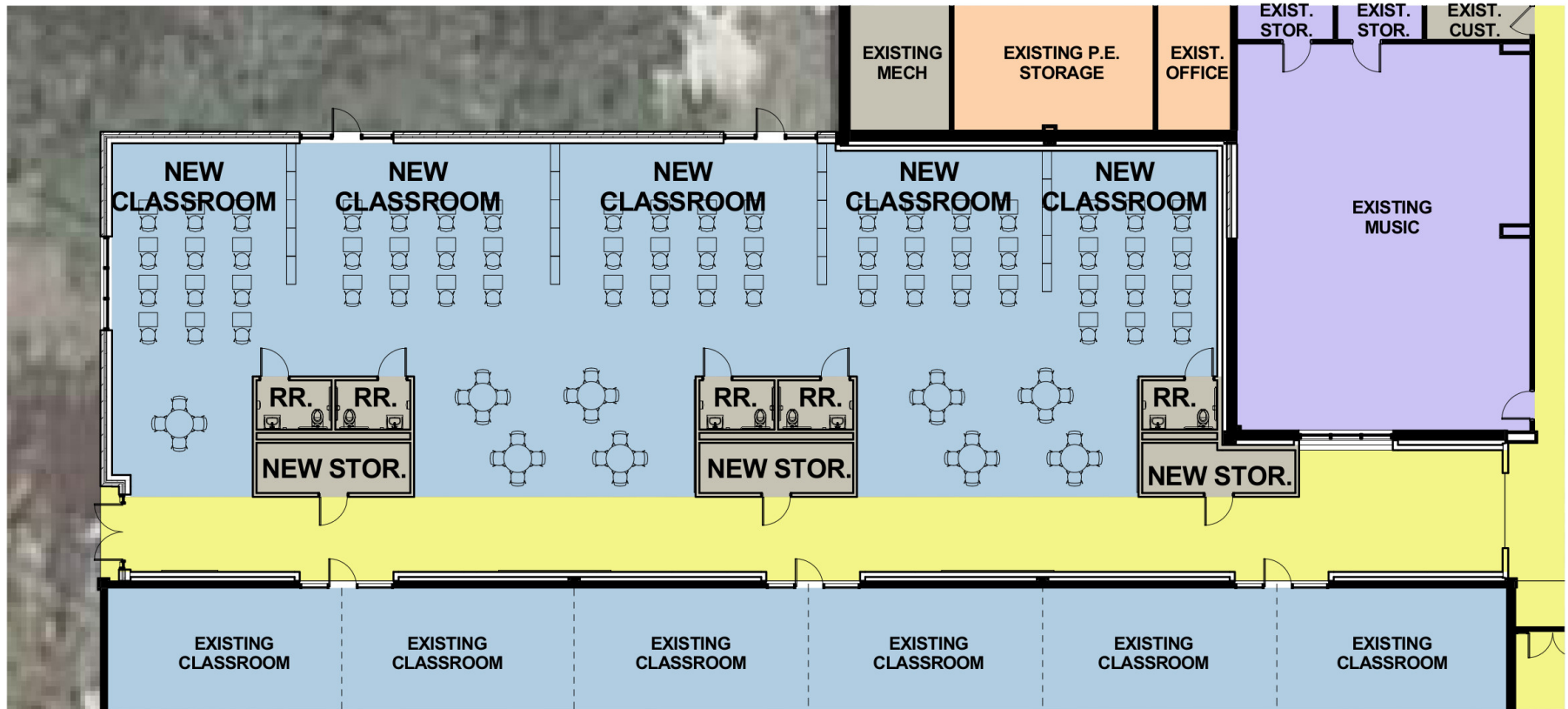

# ENLARGED FLOOR PLAN - EAST

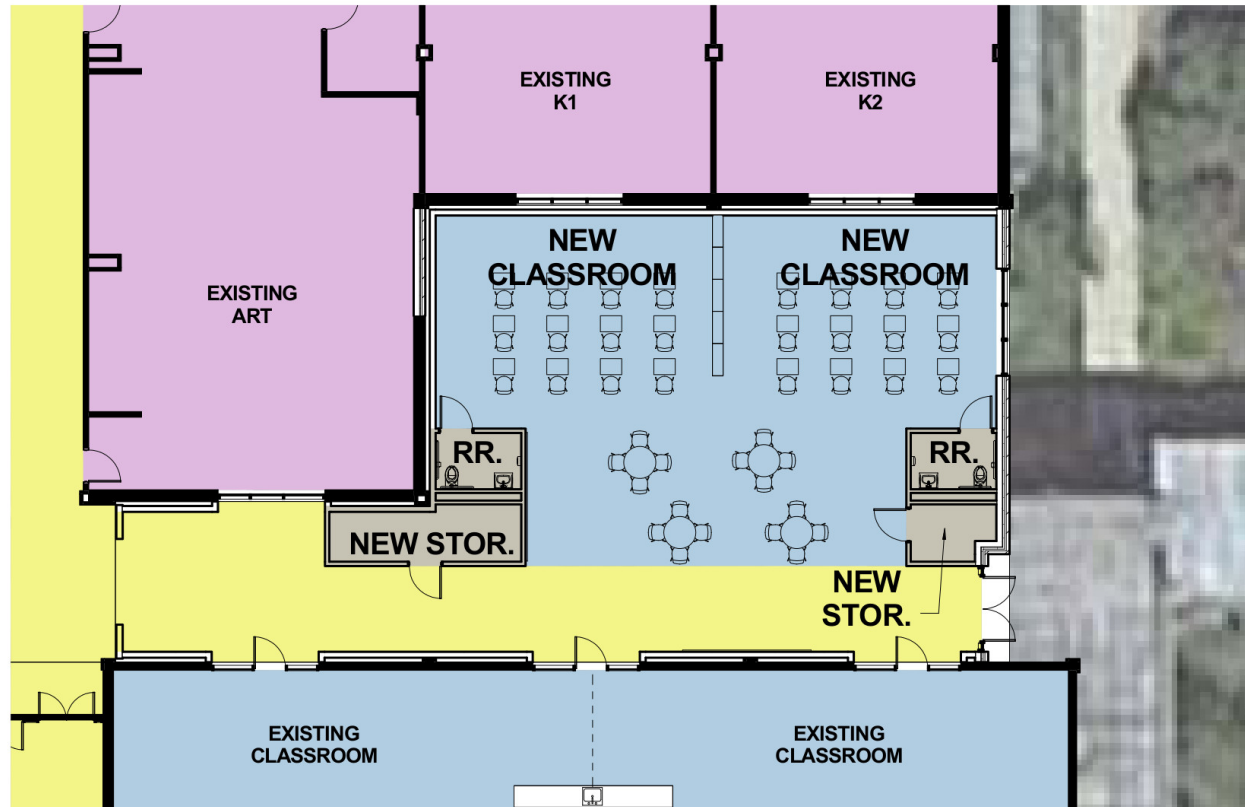



## EXTERIOR IMAGE



## EXTERIOR IMAGE





## EXTERIOR IMAGE





# INTERIOR IMAGE | CLASSROOM ADDITION





# INTERIOR IMAGE | CLASSROOM ADDITION



# PROJECT SCHEDULE

---



Preliminary Design Meetings.....	September 4, 2015 – November 13, 2015
<b>Present Design to the Board of Trustees for Approval.....</b>	<b>November 16, 2015</b>
Construction Document Phase.....	November 17, 2015 – March 4, 2016
Release Drawings to Interested Contractors.....	March 7, 2016
Receive Contractor Proposals.....	March 29, 2016
Present Contract for Construction to the Board of Trustees for Approval.....	April 18, 2016
Issue Notice-to-Proceed.....	April 19, 2016
Construction Phase.....	April 19, 2016 – December 15, 2016
<b>Substantial Completion Date.....</b>	<b>December 15, 2016</b>
Warranty Phase.....	December 15, 2016 – December 15, 2017
11-Month Walk-Through.....	November 15, 2017



## PROBABLE PROJECT COSTS

---

### **Renovations and Additions to Johnson Elementary School**

---

Addition of seven (7) open concept classrooms with restrooms  
 Add a security vestibule at building entry  
 Renovate existing single occupant restrooms  
 Install new sprinkler system throughout the building  
 Replace all existing roofing  
 Relocate existing garden

---

**Total Estimated Project Cost.....\$2,426,962.00**

Funds Available for Construction.....\$2,426,962.00

Project Soft Costs.....\$364,044.00

Professional Fees

Geotech Reports, Surveys, Material Testing

Fixtures, Furniture & Equipment

---

**Total Established Project Cost.....\$2,791,006.00**

Alternate #1 - Add new parking at main entry drive.....\$100,000.00

*Note that the allowance for Construction Inflation, as established in the 2014 Bond Referendum, has not been included in the costs shown above.*



**Thank You**

BRYAN  
INDEPENDENT  
SCHOOL DISTRICT