

**PBK K-12**

# Performing Arts Center

Bryan Independent School District \ \ Bryan, Texas

Design Presentation

May 4, 2015



## INTRODUCTION

As part of the new Stephen F. Austin Middle School project, major renovations will be made to the existing auditorium. Renamed as the “Bryan Independent School District Performing Arts Center”, the following improvements will be made:

### Planned Improvements:

- 1) Install new sound system.
- 2) Install new projector screen – motorized type, 16’ wide hung from existing batten.
- 3) Construct new sound/control booth at top of auditorium seating with accessible entrance.
- 4) New “follow spot” rooms adjacent to control area.
- 5) Renovate restrooms to increase fixture count and add accessible fixtures.
- 6) Renovate front lobby (replace and raise ceiling, new lighting throughout, remove all wood paneling and replace with new laminate panels).
- 7) Replace seating and add two (2) new intermediate aisles.
- 8) Install new sidewalls in auditorium.
- 9) Repaint existing ceiling in the auditorium area – patch and repair damaged areas.
- 10) Extend front of the stage for accessible access to stage area. Include ADA lift.
- 11) New proscenium opening with paneling on sides of stage entrance.
- 12) Remove two rows of seating at the front of the stage and fill in for “orchestra area”.
- 13) New house lighting throughout / light shelves in the auditorium space.
- 14) New roof – check the roof drains as well – replace leader lines as an alternate.
- 15) New carpet at the auditorium – major aisles and walks only, not within seating area – that will remain concrete.
- 16) Replace damaged glass at front entrance.
- 17) Create weather vestibule.
- 18) Provide new building signage.
- 19) New / modified handrail / guardrails at existing stairs.
- 20) New concealed ADA lift from stage down to the new “orchestra area”.
- 21) New stairs down into bomb shelter – remove the ships ladder and bleacher style stairs.
- 22) Install perforated covers for the floor vents – these are apparently part of the return air system.
- 23) Provide a “cry room”, with audio visual, off of the lobby of the auditorium.
- 24) Renovate concession/mechanical room.



# EXISTING PHOTOS



# EXISTING PHOTOS



# COMPOSITE SITE PLAN

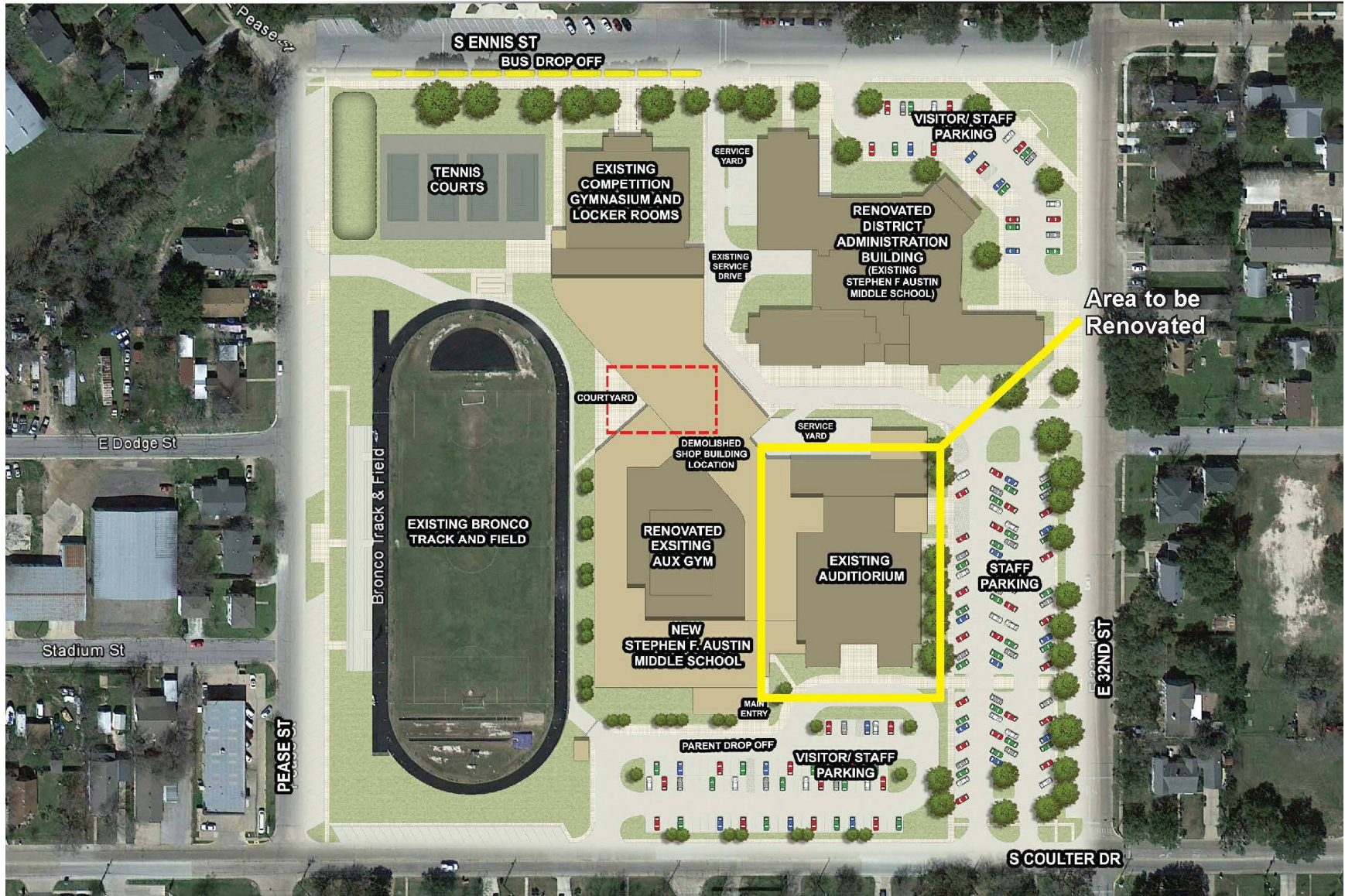

# COMPOSITE FIRST FLOOR PLAN

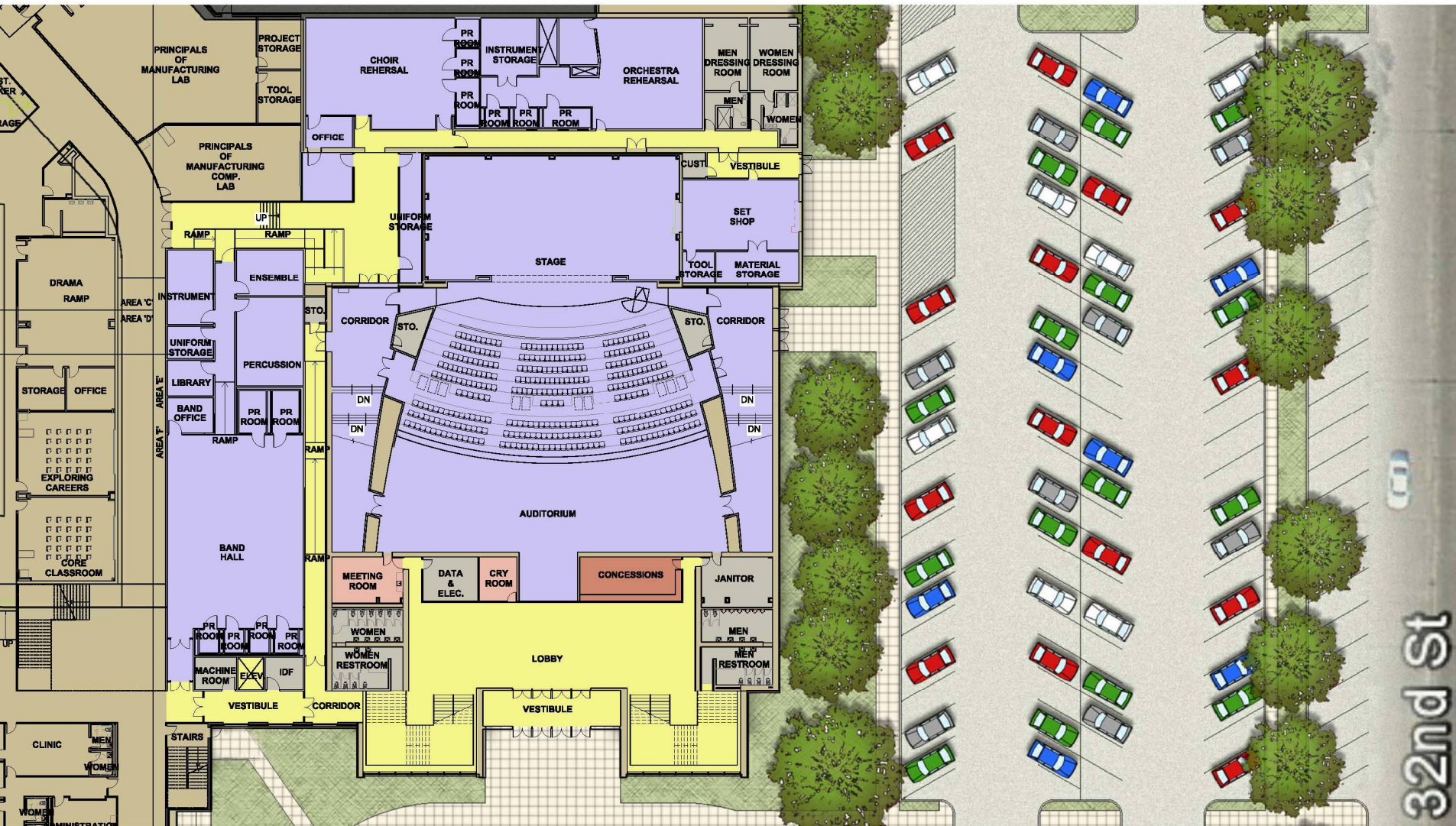

# COMPOSITE SECOND FLOOR PLAN

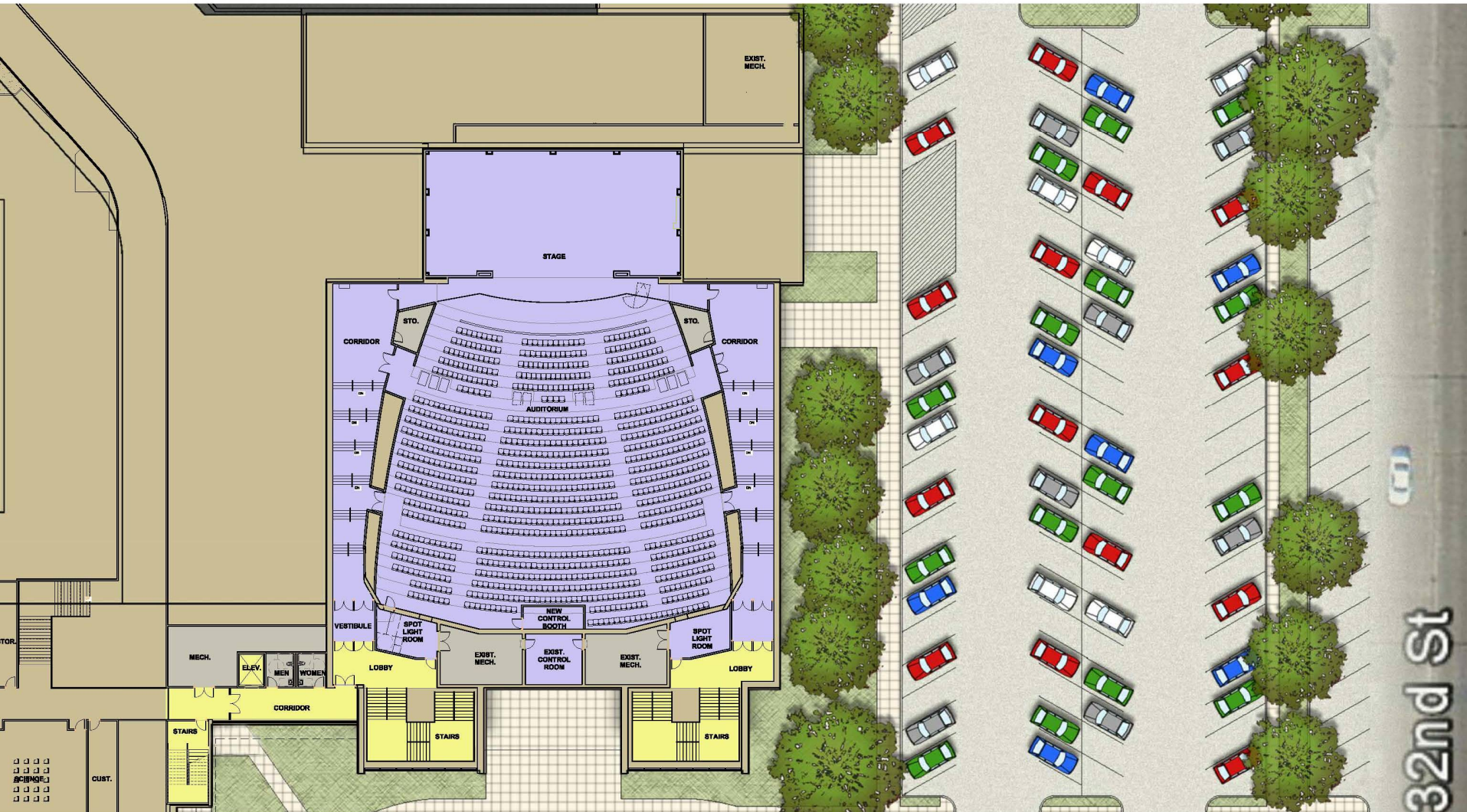

# EXTERIOR IMAGE















**Thank You**

INDEPENDENT  
SCHOOL DISTRICT

